

# Formal Joint Consultation to reduce the capacity and extend the age range at Malpas Church in Wales Primary School with effect from September 2024

19 June – 30 July 2023



If you would like this information in any other format, for example braille or large print, or help with interpretation in a different language, please contact Newport City Council on 01633 656656 or by emailing [school.reorg@newport.gov.uk](mailto:school.reorg@newport.gov.uk)

**English**

Os hoffech yr wybodaeth hon ar unrhyw ffurf arall er enghraifft braille neu brint bras, neu os hoffech help gan ddehonglydd iaith arall, cysylltwch â Chyngor Dinas Casnewydd ar 01633 656656 neu e-bostiwrch [school.reorg@newport.gov.uk](mailto:school.reorg@newport.gov.uk)

**Welsh**

如果您希望以其他格式獲取以上信息，例如凸字及大字體印刷，或者如您有口語翻譯的需求，請與新港市市政府聯繫。電話：01633 656656 郵箱 [school.reorg@newport.gov.uk](mailto:school.reorg@newport.gov.uk)

**Cantonese**

Pokud byste chtěli tyto informace v libovolném jiném formátu, například braillovém písmu nebo velkém tištěném textu nebo pomoci s tlumočením v jiném jazyce, kontaktujte Newport City Council na čísle 01633 656656 nebo e-mailem [school.reorg@newport.gov.uk](mailto:school.reorg@newport.gov.uk)

**Czech**

اگر شما این اطلاعات را در فرمت دیگر می خواهید مثلاً بریل (الفبا نابینایان) یا چاپ بزرگ یا کمک به تفسیر در زبان دیگر، لطفاً با شورای شهر Newport City Council [school.reorg@newport.gov.uk](mailto:school.reorg@newport.gov.uk) یا به این آدرس ایمیل کنید 01633 656656 تماس بگیرید

**Farsi**

Ha szeretné ezt az információt másmilyen formátumban, például Braille-írással vagy nagybetűvel nyomtatottan vagy szeretne fordítást különböző nyelven akkor legyen szives kapcsolatba lépni a Newporti Tanáccsal a 01633 656656 telefonszámon vagy emailezzen a [school.reorg@newport.gov.uk](mailto:school.reorg@newport.gov.uk)

**Hungarian**

Jei norite gauti aukščiau pateiktą informaciją kitais formatais, pvz., "Brailio raštu" ir dideliu šriftu spausdinimu, arba jei turite žodinį vertimą, susisiekitė su Niuporto miesto vyriausybe. Tel: 01633 656656. Elektroninis Paštas: [school.reorg@newport.gov.uk](mailto:school.reorg@newport.gov.uk)

**Lithuanian**

如果您希望以其他格式获取以上信息，例如盲文及大字体印刷，或者如您有口语翻译的需求，请与新港市市政府联系。电话：01633 656656 邮箱：[school.reorg@newport.gov.uk](mailto:school.reorg@newport.gov.uk)

**Mandarin**

Jeśli chcesz te informacje w innym formacie, np. Braille'em czy dużym drukiem, lub pomoc przy tłumaczeniu w innym języku, prosimy o kontakt z Urzędem Miasta Newport na 01633 656656 lub wysyłając maila na [school.reorg@newport.gov.uk](mailto:school.reorg@newport.gov.uk)

**Polish**

Se você quiser essa informação em qualquer outro formato, por exemplo braille ou impressão em letra grande, ou ajuda com a interpretação em um idioma diferente, entre em contato com a Câmara Municipal de Newport através do número 01633 656656 ou enviando um email para [school.reorg@newport.gov.uk](mailto:school.reorg@newport.gov.uk)

**Portuguese**

Dačã doritã aceastã informație în alt format, de exemplu Braille sau în format mare, sau ajutor cu interpretarea în alta limbã, vã rugãm sã contactați Newport City Council la numãrul de telefon : 01633656656 sau prin e-mail-ul: [school.reorg@newport.gov.uk](mailto:school.reorg@newport.gov.uk)

**Romanian**

Если вы хотите получить вышеуказанную информацию в других форматах, таких как шрифт Брайля и большой шрифт, или если у вас есть необходимость в устном переводе, обратитесь в управление города Ньюпорт. Тел: 01633 656656 Электронная почта : [school.reorg@newport.gov.uk](mailto:school.reorg@newport.gov.uk)

**Russian**

V prípade, že potrebujete tieto informácie v inom formáte, ako napríklad Brajlove písmo alebo veľká tlač alebo potrebujete pomoc s prekladom alebo tlmočením do iného jazyka, prosím kontaktujte Newport City Council na telefónnom čísle 01633 656656 alebo mailom na [school.reorg@newport.gov.uk](mailto:school.reorg@newport.gov.uk)

**Slovak**

Si desea esta información en cualquier otro formato, por ejemplo braille o letra grande, o ayuda con la interpretación en otro idioma, por favor póngase en contacto con el Ayuntamiento de Newport al 01633 656656 o por correo electrónico a [school.reorg@newport.gov.uk](mailto:school.reorg@newport.gov.uk)

**Spanish**

اگر آپ یہ معلومات کسی دوسری شکل میں حاصل کرنا پسند کریں گے مثال کے طور پر بریل (نابینا اشخاص کے لیے) یا بڑے پرنٹ میں یا دوسری سے اس نمبر پر رابطہ کریں Newport City Council میں ترجمے کے لیے تو برائے مہربانی نیوپورٹ سٹی کونسل 01633 656656 یا اس پتہ پر ای میل کریں [school.reorg@newport.gov.uk](mailto:school.reorg@newport.gov.uk)

**Urdu**

Information can also be arranged in other community languages if needed. Please contact us on 01633 656656 to arrange.

## Contents

<b>Introduction</b> .....	3
<b>The Consultation Process</b> .....	4
Consultation .....	5
Arrangements for the participation of children and young people .....	5
Who will we consult with?.....	6
What do you have to consider?.....	6
<b>The Proposal</b> .....	7
<b>Reduction in Published Admission Number (PAN) from 54 to 45</b> .....	8
Current and Past Pupil Numbers – Malpas Church in Wales Primary School.....	9
Forecast Pupil Numbers – Malpas Church in Wales Primary School.....	9
Current and Past Pupil Numbers – Newport High Cluster Primary Schools .....	9
Forecast Pupil Numbers – Newport High Cluster Primary Schools .....	10
Impact of Reduced PAN in Malpas Church in Wales Primary School 2024 - 2027 .....	10
<b>Establishing a 16-place (FTE) nursery class and thereby increasing the age range to 3-11 years</b> .....	10
Current and Past Pupil Numbers – Local Nursery Classes .....	11
Impact of creation of a 16-place nursery class at Malpas Church in Wales Primary School .....	11
<b>What Will The Proposal Provide?</b> .....	12
Illustrative class structure at Malpas Church in Wales – mixed-age classes.....	12
Quality and Standards.....	13
When Will This Be Effective? .....	16
Cost .....	16
<b>Alternative Options Considered</b> .....	16
What will the proposal achieve? .....	17
<b>School Organisation Arrangements</b> .....	17
Catchment area.....	17
Admissions .....	17
Transport.....	18
<b>Consultation Response Pro-forma</b> .....	20

## Introduction

This is a formal consultation on a joint proposal put forward by the Governing Body of Malpas Church in Wales Primary School together with Newport City Council:

**“To reduce the published admission number of the school from 54 to 45 from September 2024; and to extend the age range from 4-11 to 3-11 with effect from September 2025”**

This is your chance to ask questions and make comments that will be considered when the Council decides how to proceed.

**This formal consultation period:**

- **Begins on 19 June 2023**
- **Ends at midnight on 30 July 2023**

## Background

Malpas Church in Wales Primary School is an English-medium voluntary controlled primary school located on Yewberry Close, in the Malpas ward. The school has a published admission number (PAN) of 54 pupils with an age range of 4-11 years.

Over recent years, the number of pupils attending Malpas Church in Wales Primary School has decreased significantly. As of January 2023 there were 25% surplus places at the school. Pupil forecasts indicate that the number of surplus places will continue to increase at the school over the next 5 years.

Malpas Church in Wales Primary School is the only primary school in the Newport High School cluster that does not provide a nursery class. Previously, pupils attending Kimberley Nursery School would often progress to Malpas Church in Wales Primary School. In March 2021, the proposal to amalgamate Fair Oak Nursery School and Kimberley Nursery School into a single nursery school on the Fair Oak Nursery site from September 2021 was approved. Therefore, from September 2021, the availability of maintained nursery places in the Malpas/Bettws area has been reduced by 80. During the consultation to amalgamate the nursery schools, the leadership team at Malpas Church in Wales Primary School raised concerns about the potential impact of this decision on the number of pupils attending the school.

By bringing forward this proposal it is intended to provide equity of provision under a 3-11 model across all primary schools within the Newport High School cluster. It will also make good use of the available space and provide stability for planning and staffing the classes in the school.

## The Consultation Process

As part of the 'School Standards and Organisation (Wales) Act 2013', before a proposal is published, first it must be subject to consultation. The consultation process is made up of a number of stages, as presented in the table below:

Stage	Description	Duration
1	<p><b>Consultation</b></p> <p>Before a school organisation proposal is published, first the proposal must be subject to consultation. The consultation period represents an opportunity for people to learn about the proposal, ask questions and tell the Governing Body of Malpas Church in Wales Primary School and the Council what they think.</p>	Usually 6-8 weeks
2	<p><b>Consultation Report</b></p> <p>All views expressed during the consultation period are recorded and summarised into a consultation report, which includes responses from the Governing Body of Malpas Church in Wales Primary School and/or the Council. The report is published on the School's website and the Council's website. The report will be considered when the Governing Body and the Council decide on the way forward.</p>	Published at least 2 weeks prior to publication of the statutory notice
3	<p><b>Statutory Notice</b></p> <p>If it is decided to proceed, a statutory notice is published on Malpas Church in Wales Primary School's website and the Council's website and posted at the gates of the affected school for a minimum of 28 days. This stage represents the formal objection period which allows people to object to the proposal.</p>	Minimum of 28 days (including 15 school days)
4	<p><b>Objection Report</b></p> <p>If no objections are received, the proposal can move straight to determination by the Governing Body of Malpas Church in Wales Primary School and the Council's Cabinet Member for Education &amp; Early Years. If objections are received, these are summarised in an objection report which includes responses from the Governing Body and/or the Council. The report is published on the School's website and Council's website and considered when the Council decides on the way forward.</p>	Published within 28 days of the end of the objection period
5	<p><b>Determination</b></p> <p>Malpas Church in Wales Primary School and/or the Council will take into account any objections received and the Governing body of the school and the Council will make the final decision on the proposal.</p>	Decision is made within 16 weeks of the end of the objection period
6	<p><b>Decision Notification</b></p> <p>Following the decision being made, stakeholders will then be informed of the outcome by way of a decision letter, which will also be published on Malpas Church in Wales Primary School's website and the Council's website.</p>	

## Consultation

The consultation period represents stage 1 of the consultation process and is an opportunity for people to learn about the proposal, ask questions and make comments that will be recorded and summarised in a consultation report. This report will be published on Malpas Church in Wales Primary School's website and the Council's website and will be considered when the Governing Body of Malpas Church in Wales Primary School and the Council decide on the way forward.

The consultation will involve 2 drop-in sessions with those affected by the proposal, where school staff/ governors and Council officers will be on hand to explain the proposal in more detail and answer any questions:

Table 1: Drop-in Sessions		
Location	Date & Time	Session
Malpas Church in Wales Primary School	27 June 15:00 - 16:00	Drop-in
Malpas Church in Wales Primary School	4 July 09:00 – 10:00	Drop-in

## Questions

Questions can be submitted by email to [school.reorg@newport.gov.uk](mailto:school.reorg@newport.gov.uk) and Council officers will generally provide a response within 7 days in consultation with the school.

## Consultation responses

Consultation responses should be submitted using the online response pro-forma available at [www.newport.gov.uk/schoolreorganisation](http://www.newport.gov.uk/schoolreorganisation). Responses can also be submitted by email to [school.reorg@newport.gov.uk](mailto:school.reorg@newport.gov.uk). Consultation responses submitted via e-mail should be clearly identified as consultation responses, otherwise they will be treated as a query and not formally registered. Alternatively, the pro-forma enclosed can be returned to the Education Information and Development Officer, Room 425w, Newport City Council, Civic Centre, Newport NP20 4UR. **Only responses submitted using these methods will be considered as a response to the consultation.**

Social media platforms such as Twitter and Facebook will also share information on the proposed changes.

Please note that negative responses received during the consultation period will not be counted as objections to the proposal, they will be recorded as adverse comments. Objections can only be registered following the publication of a statutory notice. **The deadline for all consultation responses is midnight on 30 July 2023.**

## Arrangements for the participation of children and young people

A Children and Young People's Everyday Summary Version of this consultation has been produced. Both this and the full version are available via the NCC website at [www.newport.gov.uk/schoolreorganisation](http://www.newport.gov.uk/schoolreorganisation). Hard copies can also be requested by emailing [school.reorg@newport.gov.uk](mailto:school.reorg@newport.gov.uk) or by telephoning 01633 656656, and can also be found at Malpas Church in Wales Primary School. Pupils at Malpas Church in Wales Primary School will be consulted by arrangement with the school.

## Who will we consult with?

- The Headteacher, teachers, staff and the governing body of Malpas Church in Wales Primary School and Malpas Park Primary School;
- Pupils at Malpas Church in Wales Primary School;
- Parents, carers and guardians of pupils attending Malpas Church in Wales Primary School;
- The Headteachers and Governing Bodies of all Newport schools;
- All Newport City Council elected members;
- All Newport Community Councils;
- The Welsh Ministers;
- Assembly Members (AMs) and Members of Parliament (MPs) representing the area served by the school subject to the proposal;
- Other Local Authorities across the South East Wales Consortium region, including relevant Transport departments;
- The South East Wales Education Achievement Service;
- The Church in Wales, Diocese of Monmouth;
- Roman Catholic Archdiocese;
- Estyn;
- Teaching and staff trade unions representing teachers and staff at all Newport schools;
- The Early Years Development and Childcare Partnership
- All non-maintained registered nursery education providers in the local area
- The Police and Crime Commissioner for Gwent;
- Gwent Police;
- South Wales Fire and Rescue Service;
- Aneurin Bevan University Health Board;
- Public Health Wales;
- Newport Serennu Centre;
- SNAP Cymru;
- Gwent Association of Voluntary Organisations;
- Preventative Services.

## What do you have to consider?

The remainder of this document sets out the rationale for the proposal. We would like you to consider the information contained within the document and to hear your views as to whether or not you support the proposal.

# The Proposal

This is a joint proposal by Newport City Council and the Governing Body of Malpas Church in Wales Primary School.

- the Council proposes to reduce the Published Admission Number (PAN) of the school from 54 to 45 from September 2024, resulting in the school capacity being reduced by 63 pupil places from 378 to 315, and;
- the Governing Body proposes to extend the age range of the school from 4-11 years to 3-11 years from September 2025, enabling the establishment a 16-place nursery class as at this date.

Over the past 5 years the number of pupils that attend Malpas Church in Wales Primary School has been decreasing. Malpas Church in Wales Primary School forms part of the Newport High cluster, which includes Crindau Primary, Malpas Church in Wales Primary, Malpas Court Primary, Malpas Park Primary, Millbrook Primary and Monnow Primary schools.

In the academic year 2017/18 there were a total of 367 pupils on roll at Malpas Church in Wales Primary school, but this decreased to 300 pupils in 2021/22; leaving 20.63% surplus places at the school. Numbers at the other schools in the cluster have remained relatively stable during this time. Pupil forecasts suggest that by 2026/27 there will only be 243 pupils at Malpas Church in Wales Primary School, resulting in 35.71% surplus places. The decreasing number of pupils will make planning and managing the school difficult, and potentially leave parts of the school unused which is not cost-effective.

The school currently operates on a 2 form-entry basis, with two linked classes of up to 27 pupils in each year group.

It is proposed that the pupil admission number (PAN) of the school is reduced from 54 to 45 across the school from September 2024. However, the reduced PAN would not affect any pupils already on roll at the school. Therefore, if on the implementation date any year group contained more than 45 children, these children would continue to attend the school and would not be displaced. The new PAN would therefore apply to any current year groups operating at or below that number, and any future admissions only.

Reducing the PAN will reduce the number of surplus places, making planning and managing the school easier and more cost-effective, and enable the Governing Body to extend the age range of the school to support establishment of a nursery class. This will provide Early Years education places and increase consistency and familiarity for pupils who then transition into Reception class the following year.

Establishing a nursery class will increase the number of funded nursery places available across the city and enable positive transition into statutory mainstream education. The nursery class will utilise a classroom which can be made available due to low pupil numbers currently attending the school.

## Affected Schools

The school directly affected by this proposal is Malpas Church in Wales Primary School. It is not expected that any other school will be significantly affected. However, due to proximity and the proposed establishment of a nursery class, there is a possibility of a small impact on Malpas Park Primary School:

- Malpas Park Primary School (0.7 miles). Malpas Park Primary School is an English-language community maintained primary school. It has an admission number of 30 for Reception to Year 6 classes and a nursery admission number of 32.



The above school could potentially be affected in three possible ways:

- 1) The new nursery school places at Malpas Church result in lower nursery intakes in neighbouring schools.

In the past, families living in the Malpas Church in Wales Primary School catchment area have made use of the other local nursery schools, with the majority attending Kimberley Nursery School. Following the amalgamation of Kimberley and Fair oak nursery schools on the Fair oak site from September 2021, the other schools in the area, notably Malpas Park Primary School, have taken more nursery age pupils from the Malpas Church catchment area. The creation of a nursery class at Malpas Church in Wales Primary School may therefore have limited impact on nursery pupil numbers at Malpas Park Primary School. However, the proposal would most likely return numbers to levels similar to those experienced before the amalgamation of Kimberley and Fair oak nursery schools.

- 2) Children attending Malpas Church Primary School nursery could choose to apply for a Reception place there, when they may otherwise have attended another local nursery and school.

Birth rates for the school catchment area suggest that the school has historically taken a significant proportion of out-of-catchment pupils from the wider area. If all in-catchment pupils attend Malpas Church in Wales Primary School, the impact on other local schools is not expected to be significant when compared to recent years.

- 3) If demand for statutory-age school places in the area increases, and Malpas Church in Wales Primary School becomes over-subscribed, neighbouring schools may see an increase in applications for school places.

Pupil forecasts indicate that pupil populations will remain stable or decrease slightly over the coming years. Intake numbers at Malpas Church in Wales Primary School are not expected to exceed 40 pupils, and all other schools in the cluster are expected to be operating within their existing capacities.

## **Reduction in Published Admission Number (PAN) from 54 to 45**

The school currently operates on a 2 form-entry basis, with two linked classes of up to 27 pupils in each year group. This provides a total of 378 pupil places across the seven statutory age year groups. Declining pupil numbers, with particularly low Reception intakes in the last three years have resulted in an increasing number of surplus places at the school, and present some challenges for the school in budget management, staffing and class structure.

From September 2024, it is proposed that the PAN will reduce to 45 from 54 across all year groups. However, the reduced PAN would not affect any pupils already on roll at the school. Therefore, if on the implementation date any year group contained more than 45 children, these children would continue to attend the school and would not be displaced. The new PAN would apply to any current year groups operating at or below that number, and any future admissions only.

## Current and Past Pupil Numbers – Malpas Church in Wales Primary School

**Table 2 - Recent pupil numbers – Malpas Church in Wales Primary (Reception – Y6)**

Pupil Numbers 2017-2023 – PLASC									
Year	R	1	2	3	4	5	6	Total	% Surplus
<b>PAN</b>	<b>54</b>	<b>54</b>	<b>54</b>	<b>54</b>	<b>54</b>	<b>54</b>	<b>54</b>	<b>378</b>	
2017/18	52	52	52	55	46	53	57	367	2.91%
2018/19	48	48	51	52	54	44	52	349	7.67%
2019/20	50	48	48	47	49	52	41	335	11.38%
2020/21	36	48	48	47	40	48	47	314	16.93%
2021/22	35	35	47	48	48	39	48	300	20.63%
2022/23	22	36	37	45	48	52	41	281	25.66%

## Forecast Pupil Numbers – Malpas Church in Wales Primary School

**Table 3 - Forecast pupil numbers – Malpas Church in Wales Primary (Reception – Y6)**

Year	R	1	2	3	4	5	6	Total	% Surplus
<b>PAN</b>	<b>54</b>	<b>54</b>	<b>54</b>	<b>54</b>	<b>54</b>	<b>54</b>	<b>54</b>	<b>378</b>	
2022/23*	22	36	37	45	48	52	41	281	25.66%
2023/24	24	23	37	37	46	48	52	267	29.36%
2024/25	27	26	24	38	37	44	45	241	36.24%
2025/26	35	28	28	26	40	38	44	239	36.77%
2026/27	39	36	30	32	28	40	38	243	35.71%

\* Pupil Numbers 2022/23 – PLASC

## Current and Past Pupil Numbers – Newport High Cluster Primary Schools

**Table 4 – Newport High cluster primary school pupil numbers R-Y6 2017-2023**

**Mainstream Pupil Numbers 2017-2023 – PLASC**

School	Capacity (2022)	2017 - 2018	2018 - 2019	2019 - 2020	2020 - 2021	2021 - 2022	2022 - 2023	Surplus Places 2022/23
Crindau Primary	315	299	287	292	287	286	303	3.81%
Malpas Church in Wales Primary	378	367	349	335	314	300	281	25.66%
Malpas Court Primary	210	197	192	184	182	190	191	9.05%
Malpas Park Primary	210	200	205	202	200	199	209	0.48%
Millbrook Primary	315	230	250	256	266	283	276	12.38%
Monnow Primary	420	319	321	322	302	296	307	26.90%
<b>Cluster Total</b>	<b>1,848</b>	<b>1,612</b>	<b>1,604</b>	<b>1,591</b>	<b>1,551</b>	<b>1,554</b>	<b>1,567</b>	<b>15.21%</b>

## Forecast Pupil Numbers – Newport High Cluster Primary Schools

School	Capacity (2022)	2022 – 2023*	2023 - 2024	2024 - 2025	2025 - 2026	2026 - 2027	Surplus Places 2026/27
Crindau Primary	315	303	280	287	285	283	32
Malpas Church in Wales Primary	378	281	267	241	239	243	135
Malpas Court Primary	210	191	186	186	186	181	29
Malpas Park Primary	210	209	199	198	198	201	9
Millbrook Primary	315	276	297	293	285	288	27
Monnow Primary	420	307	299	296	286	286	134
<b>Cluster Total</b>	<b>1,848</b>	<b>1,567</b>	<b>1,539</b>	<b>1,529</b>	<b>1,495</b>	<b>1,486</b>	<b>366</b>

\*Pupil Numbers 2022/23 – PLASC

Table 5, above, shows a forecast position of 366 surplus places across the cluster by 2026-27. This equates to almost 20% and is double the amount considered suitable to manage in-year migration and enable efficient budget management. A significant proportion of these surplus places are forecast to be at Malpas Church in Wales Primary School.

### Impact of Reduced PAN in Malpas Church in Wales Primary School 2024 - 2027

The table below shows that by reducing the admission number to 45, the number of surplus places across the school is reduced considerably by 2026/27, from 135 (35.71%) shown in tables 3 and 5; to 72 (22.86%).

Year	R	1	2	3	4	5	6	Total
<b>PAN</b>	45	45	45	45	45	45	45	315
<b>2024/25</b>	27	26	24	38	37	44	45	241
<b>Places available</b>	18	19	21	7	8	1	0	74
<b>2025/26</b>	35	28	28	26	40	38	44	239
<b>Places available</b>	10	17	17	19	5	7	1	76
<b>2026/27</b>	39	36	30	32	28	40	38	243
<b>Places available</b>	6	9	15	13	17	5	7	72

### Extending the age range of the school to 3-11 years and thereby establishing a 16-place (FTE) nursery class

Extending the age range of the school will support the establishment of a nursery class. This in turn will increase the number of funded nursery places available across the city and enable positive transition into statutory mainstream education. The nursery class will utilise a classroom which can be made available due to low pupil numbers currently attending. This will provide Early Years education places in the school and increase consistency and familiarity for pupils who then transition into Reception class the following year.

The table on the following page shows the number of funded nursery and Early Years places available in the local area, and the number of unfilled places at the last two census dates. This indicates that there are very few funded 'rising 3' nursery/Early Years places available in the local area.

### Current and Past Pupil Numbers – Local Nursery Classes

<b>Table 7 – Local Nursery School pupil numbers 2018-2023</b>													
Nursery Pupil Numbers - Autumn Term Census (Oct) Rising 3 January intake Pupil Numbers– Spring Term (Jan)													
School	PAN (2023)	2018 - 2019		2019 - 2020		2020 - 2021		2021 - 2022		2022 - 2023		Available Places 2022/23	
		Oct	Jan	Oct	Jan	Oct	Jan	Oct	Jan	Oct	Jan	Oct	Jan
Malpas Court Primary**	39	37	1	31	9	23	12	26	4	28	8	11	3
Malpas Park Primary	32	25	5	24	7	22	7	30	2	28	4	4	0
Millbrook Primary	32	31	2	31	1	32	0	25	6	30	2	2	0
Monnow Primary	60	41	17	42	15	46	12	40	14	46	7	14	7
Chuckles Nursery#	32	21	18	28	8	15	14	23	17	14	18	18	0
Tiny Tots Nursery#	24	18	8	13	1	11	3	18	8	17	5	7	2

\*\*Malpas Court Primary School currently offer 'morning only' nursery.  
#Non-maintained settings

Chuckles Nursery and Tiny Tots Nursery are both non-maintained settings. Chuckles Nursery had an extension built in 2021/22 which increased the number of registered places offered from 24 to 32. Due to demand in early 2020 Tiny Tots Nursery also increased the number of registered places offered from 18 to 24. This shows there is demand for nursery places within the Malpas and Bettws area.

### Impact of extending the age range and therefore creating a 16-place nursery class at Malpas Church in Wales Primary School

The proposed establishment of a nursery class at Malpas Church in Wales Primary School will create an additional 32 half-day Early Years education places in the Malpas area. It is anticipated that this will encourage parents living in the locality to take up these funded education places. The increased availability of nursery places will result in more 'rising 3' places being available for children giving parents more options for nursery education. It will also help to address the gap in provision that can occur when children leave Flying Start at 3 years of age. This in turn should help improve children's transition into mainstream education at the age of four.

If uptake of nursery places in the area does not improve as a result of the increased offer, then a similar number of pupils as currently attend nursery classes could be spread across more local providers. In this case some providers, including the new provision, may reduce their offer by running morning or afternoon sessions only.

## Building Condition

The current condition of the buildings affected by this proposal has been judged on a scale of A to D as follows:

Table 8 - Building Condition	
Malpas Church in Wales Primary	C

## What Will The Proposal Provide?

The joint proposal will legally reduce the PAN of Malpas Church in Wales Primary School from 54 to 45 from September 2024 and will see the capacity of the school reduced by 63 places from 378 to 315 from this date; as a consequence, the age range of the school will be extended from 4-11 to 3-11 from September 2025, enabling the establishment of a nursery class from this same date.

The school operates on a 2 form-entry basis, with two linked classes of up to 27 pupils in each year group. However, due to lower intake numbers in recent years education is currently provided in mixed aged classes across Reception and Year 1. It is anticipated that mixed-age class arrangements will be needed for the foreseeable future, due to the low class numbers.

The proposal will involve a formalised shift towards mixed age classes in more than one year group in the school. An illustration of how the school could operate with 45 pupils per year group is shown below. Operationally, the structure will depend on actual numbers on roll in each year group at any given time.

### Illustrative class structure at Malpas Church in Wales – mixed-age classes.

Table 10 – Illustrative class structure at Malpas Church in Wales Primary School								
	Nursery	Reception	Year 1	Year 2	Year 3	Year 4	Year 5	Year 6
Infant Class 1	16							
Infant Class 2/Conservatory		30						
Infant Class 3		15	12					
Infant Class 4			26					
Infant Class 5			7	19				
Infant Class 6				26				
Junior Class 1					23			
Junior Class 2					22			
Junior Class 3						23		
Junior Class 4						22		
Junior Class 5							36	
Junior Class 6								
Junior Class 7							9	18
Junior Class 8								27

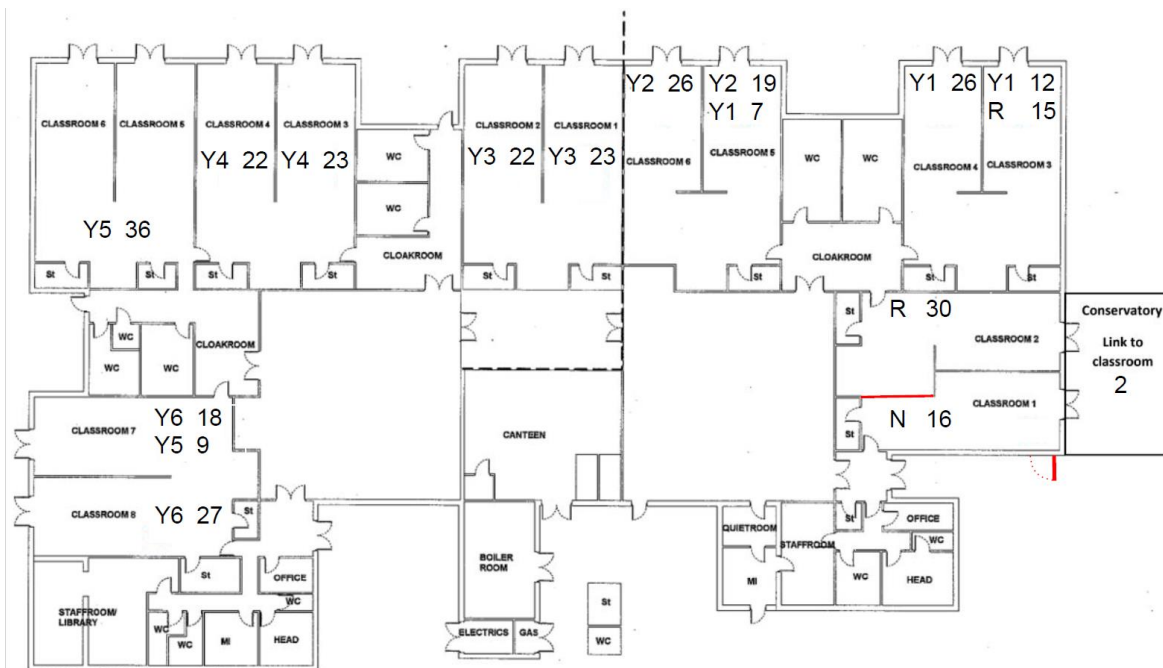

## Quality and Standards

Quality and standards in schools in Newport are monitored by Estyn and the Local Authority (LA). Estyn is the office of His Majesty’s Chief Inspector of Education and Training in Wales. It is a Crown body, established under the Education Act 1992. Estyn is independent of the National Assembly for Wales but receives its funding from the Welsh Government under Section 104 of the Government of Wales Act 1998. Estyn inspects quality and standards in education and training providers in Wales.

Malpas Church in Wales Primary School’s last inspection was November 2019 and resulted in the school being placed into the “special measures” category.

**Table 9 - Estyn Inspection – November 2019**

<b>Inspection Area</b>	<b>Judgement</b>
<b>Standards</b>	<i>Adequate and needs improvement</i>
<b>Wellbeing and attitudes to learning</b>	<i>Adequate and needs improvement</i>
<b>Teaching and learning experiences</b>	<i>Adequate and needs improvement</i>
<b>Care, support and guidance</b>	<i>Unsatisfactory and needs urgent improvement</i>
<b>Leadership and management</b>	<i>Unsatisfactory and needs urgent improvement</i>

Since this last inspection, performance against all inspection areas has significantly improved under the leadership of a new Headteacher and Chair of Governors. The Governing Body has also been strengthened through new and additional governors whose skills have complemented those of longer-standing and experienced individuals.

In November 2022, Estyn undertook a monitoring visit, and judged that the school had made sufficient progress in relation to the recommendations made in the core inspection. As a result, His Majesty’s Chief Inspector of Education and Training in Wales took the decision to remove the school from the list of schools requiring special measures.

Consideration of the potential impact of the proposal on quality and standards is aligned with the Estyn Inspection framework which has been updated for the 2022 academic year:

### ***Learning***

The proposal will not affect the standards and progress of learning in any other schools. It is expected that the proposal will have a positive impact on Learning at Malpas Church in Wales Primary School and will improve baseline capability on entering Reception class. The school will continue to receive the appropriate level of challenge and support to ensure pupils develop the key attitudes and behaviours that will help them through their lives and achieve high standards in their skills development and make progress.

### ***Wellbeing and attitudes to learning***

Pupil well-being is paramount. Pupil well-being will be monitored through the school's strategic planning and self-evaluation processes and through the local authority's 'Learn-Well' group. Malpas Church in Wales Primary School will provide pupils with a learning environment in which they feel safe and secure and where they become healthy and confident individuals. The proposed nursery class will enable the school to begin this work earlier, and therefore more effectively meet pupil needs.

### ***Teaching and learning experiences***

The quality of teaching and learning experiences will be monitored through the school's strategic planning and self-evaluation processes, with the school receiving the appropriate levels of challenge and support to ensure that Malpas Church in Wales Primary School's vision for teaching and learning is aligned to the New Curriculum, in Wales. The curriculum will be delivered through the medium of English with classroom practices successfully engaging all pupils to develop their skills, knowledge and understanding to an appropriately high level as they move through the school. By establishing a nursery class at the school will provide positive transition into statutory mainstream education.

### ***Care support and guidance***

The quality of provision for care, support and guidance will be monitored through the school's strategic planning and self-evaluation processes. The school will receive the appropriate levels of challenge and support to ensure provision for pupils' personal development and learning support meets the needs of pupils in a culture which promotes pupils' spiritual, moral, social, and cultural development. The proposed nursery class will enable the school to begin this work earlier, and therefore more effectively meet pupil needs.

### ***Leadership and management***

The proposed changes are intended to reduce surplus places at the school and stabilise class numbers thereby making budget planning less challenging. It is expected that this will have a positive effect on leadership and management At Malpas Church in Wales Primary School. The school's Leadership will receive an appropriate level of challenge and support to ensure that the school vision is well communicated and that the school's aims, strategic objectives, plans and policies focus on meeting the needs of pupils; so pupils achieve well and a safeguarding culture is promoted.

### ***Additional Learning Needs (ALN) provision***

There are three primary schools within the Newport High School cluster which host specialist ALN classes. These are at Monnow Primary School (20 places), Crindau Primary School (20 places) and Malpas Court Primary School (16 speech & language impairment places). There is no specialist ALN provision planned for Malpas Church in Wales Primary School, and this proposal will have no effect on the existing provision within the cluster or elsewhere in Newport.

## Impact on Welsh language provision

In October 2021, a parental survey was published online by Welsh Government that was developed in collaboration with Local Authority Childcare leads to inform the local Childcare Sufficiency Assessment. The parental survey was a national approach and Newport received 619 complete responses to the survey.

21% of respondents indicated that they would like to consider Welsh-medium childcare. The survey report concluded that availability and distance of travel appear to be the largest issues facing use of Welsh Medium childcare<sup>1</sup>.

From September 2023 there will be 22 AM and 22 PM Welsh-medium Flying Start placements for 2-3 year olds provided at Ysgol Gymraeg Ifor Hael which is located in the Bettws area.

There are 19 registered education places in Cylch Meithrin Brynglas for 3-4 year olds.

There are 30 maintained nursery places for 3-4 year olds offered at Ysgol Gymraeg Ifor Hael which is located in the Bettws area. The nursery currently offers 'morning only' sessions, therefore if demand for Welsh-medium nursery places increases, the school can potentially offer another 30 places in an afternoon session. The table below shows there has been sufficient places in the Nursery class over the past 6 years.

Table 11 – Local Welsh-medium nursery numbers 2017-2023															
Nursery Pupil Numbers - Autumn Term Census (Oct) Rising 3 January intake Pupil Numbers 3 – Spring Term (Jan)															
School	PAN (2023)	2017 - 2018		2018 - 2019		2019 - 2020		2020 - 2021		2021 - 2022		2022 - 2023		Available Places 2022/23	
		Oct	Jan	Oct	Jan	Oct	Jan	Oct	Jan	Oct	Jan	Oct	Jan	Oct	Jan
Ysgol Gymraeg Ifor Hael**	30	22	2	11	6	22	2	11	9	19	0	22	2	8	6

**\*\*Ysgol Gymraeg Ifor Hael currently operates a 'morning only' nursery.**

Therefore, there is sufficient Welsh-medium education provision in the Malpas and Bettws areas for children between the ages of 2 and 4 years old.

Ysgol Gymraeg Ifor Hael provides Welsh-medium education in the Bettws and Malpas communities. The school has a PAN of 30 and a Reception to Year 6 capacity of 210 pupils. Current forecasts suggest the school will have approximately 18% surplus places in the next few years, suggesting sufficiency of local provision for the short to medium term.

This proposal is to reduce the PAN and establish a nursery class at an English-medium school. The proposal has no impact on the Council's plans for growing Welsh-medium education provision across

<sup>1</sup><https://www.newport.gov.uk/documents/Care-and-Support/Childcare-Sufficiency-Assessment/Section-7-demand-for-childcare.pdf>



Newport as outlined in our 10-year Welsh in Education Strategic Plan. Details of the factors considered in making this proposal are contained within the Fairness and Equalities Impact Assessment.

### Impact on other schools

The proposal will have no detrimental impact on other Newport schools. Any impact on Malpas Park Primary School's nursery intake could be fairly easily managed.

### When Will This Be Effective?

The proposal is to legally reduce the Malpas Church in Wales Primary school PAN from 54 to 45 from September 2024 which sees the capacity of the school reduced by 63 places from 378 to 315 and extend the age range from 4-11 to 3-11 by establishing a nursery class at the school with effect from September 2025.

### Cost

#### Capital

The proposal will require some small alterations to classrooms. These costs are not expected to be significant and will be funded from the school's budget.

#### Revenue

The recurring costs associated with the staffing and running of the school will be met by Newport City Council through the school's delegated budget. The school and governing body are confident that the staffing costs for the nursery can be met from the school's budget. School funding is based on pupil numbers which are currently below the proposed capacity of the school. The proposal will not therefore negatively impact funding.

## Alternative Options Considered

The proposal has two elements, concerning both the admission number and therefore school capacity, and the age range – whether the school should have a nursery class. A range of options have been considered, as set out below, and each combination of options has also been considered to determine the preferred way forward.

### Published Admission Number and School capacity

Option #	PAN	Capacity	Appraisal
1 (no change)	54	378	Large number of surplus places, difficult to plan staffing and budget.
2	45	315	usual 1.5FE arrangement. Reduced surplus places. Sufficient capacity for forecast demand and some growth, and releases room for nursery provision. Easier to plan and budget.
3	39	273	1.5FE arrangement adjusted to best fit room sizes. Reduced surplus places, but limited capacity for growth. Releases room for nursery provision. Easier to plan and budget.

Of the above options, option 2 is the preferred option. Reducing the PAN to 45 helps to manage staffing levels and the school budget and reduces surplus places. It also releases space which can be

used to provide nursery places, while leaving some capacity for any future growth in pupil numbers due to demographic change, parental choice and migration

### Age range (nursery provision)

Option #	Age range	Nursery capacity (FTE)	Appraisal
1 (no change)	4-11	0	No nursery provision at the school; pupils start in Reception at age 4
2	3-11	16	32 part-time nursery places offered enabling children to start at age 3, improving familiarity with the school and learning.
3	3-11	24	48 part-time nursery places offered enabling children to start at age 3, improving familiarity with the school and learning. More places offered, but more staff required resulting in greater costs.

Of the above options, option 2 is the preferred option. Establishing a small nursery of 16 morning and 16 afternoon sessions will be manageable and limit any potential impact on other nursery providers, while still offering the benefits of Early Years education places in an established school setting.

On the basis of the above the proposal is to reduce the PAN to 45 and extend the age range of the school to 3-11; establishing a 16-place (Full Time Equivalent) nursery class.

### What will the proposal achieve?

The preferred proposal will see a decrease in the Malpas Church in Wales Primary School PAN from 54 to 45, therefore reducing the amount of surplus places forecast from 37% to 22% by 2026/27.

The preferred proposal will also extend the age range of the school from 4-11 to 3-11 by establishing a nursery class which will provide 32 half-day nursery places at the school and achieve a seamless pathway of transition from Nursery to statutory school provision.

## School Organisation Arrangements

### Catchment area

There will be no changes to the current primary and secondary catchment areas under this proposal.

### Admissions

Newport City Council is the admissions authority for Malpas Church in Wales Primary School, and applications for admission will continue to be assessed in accordance with the Council's School Admissions Policy.

In accordance with this policy, parents can express a preference for any school, but there is no guarantee of admission to the chosen school, even if it is the catchment school. Admission to the

school will be made in accordance with parental preference, subject to availability. Where a school is oversubscribed, preference requests will still be considered, but the Council's over-subscription criteria will be applied to determine priority.

### **Admission to Reception – September 2024**

Applications can be made using the council's on-line admissions service between 6<sup>th</sup> November 2023 and 9<sup>th</sup> January 2024. Decision notifications for on-time applications will be issued on 16<sup>th</sup> April 2024.

The proposal may not have been determined before the Reception application window opens. Therefore, parents will be notified when making an application for Malpas Church in Wales Primary School, that the school is subject to a live proposal which if approved will result in reduced capacity; parents will therefore be encouraged to include alternative school preferences when finalising their applications.

### **Admission to the Year One to Year Six Classes – September 2024**

These are denoted as in-year admission requests and can be made via an in-year application form which is available on the council website. In-year transfer applications can be submitted during the summer term 2024. (Exact date to be confirmed) Although existing pupils attending the school will not be displaced, in-year applications that would take the year group over PAN are likely to be refused. Any applications that are refused will be afforded the right of appeal.

### **Admission to Nursery – September 2025**

Applications can be made using the council's on-line admissions service between July and September 2024. Decision notifications for on-time applications will likely be issued in December 2024. (Exact dates to be confirmed)

Further information on the School Admissions policy and process can be found on the Council website at [www.newport.gov.uk/schooladmissions](http://www.newport.gov.uk/schooladmissions)

### **Transport**

Where appropriate, transport is provided in accordance with the Council's policy. There are identified safe areas for the drop-off and collection of pupils, and this will not be affected by this proposal. The Council's policy only applies to children of statutory school age and therefore the creation of a nursery class at the school will have no impact on these arrangements.

### **Governance**

There will be no changes to school governance arrangements as a result of this proposal. The governing body will continue in its current form.

### **Staffing**

There may be staffing implications for Malpas Church in Wales Primary School in terms of reducing teaching and support staff where necessary to support the reduction in pupil numbers in Reception – Y6. This includes taking into account the additional Nursery class added. This will be managed by the Headteacher and Governing Body with support from the Council's Human Resources & Occupational Development Team.

## Risks

The risks associated with this proposal, and mitigating factors are listed below:

<b>Table 12 - Risks</b>	
<b>Risk</b>	<b>Mitigating factor</b>
Demand for Malpas Church in Wales Primary School increases and the school becomes oversubscribed.	This will be closely monitored at the Planning of School Places group. Although this is unlikely due to the decreasing demand in recent years. The Council's over-subscription criteria would be used to determine the priority of applications. There are sufficient places across the cluster to meet forecast demand.
The nursery class may not receive sufficient applications when it opens.	It is difficult to predict with any certainty the number of applications that will be received. The Governing Body of Malpas Church in Wales Primary School will consider the anticipated demand for nursery places when deciding whether to take this proposal forward following consultation.

## Impact assessments

A fairness and equalities impact assessment has been completed for this proposal and is available on the council website.

## Consultation Response Pro-forma

**This response relates to the joint proposal to reduce the published admission number by 9 places from 54 to 45 from September 2024 and extend the age range from 4-11 to 3-11 by establishing a nursery class at Malpas Church in Wales Primary School with effect from September 2025.**

Your views matter. Please tell us what you think about the proposal by completing this questionnaire and returning it to either the Education Information and Development Officer, Newport City Council, Room 425W, Civic Centre, Newport NP20 4UR or Malpas Church in Wales Primary School, Yewberry Close, Malpas, Newport, NP20 6WJ. Alternatively, you can complete this form online at [www.newport.gov.uk/schoolreorganisation](http://www.newport.gov.uk/schoolreorganisation) or email your response to [school.reorg@newport.gov.uk](mailto:school.reorg@newport.gov.uk)

**The closing date for the submission of responses to this consultation is midnight on 30 July 2023.** Please note that negative responses made to this consultation will not be counted as objections to the proposal, they will be recorded as adverse comments. Objections can only be registered following the publication of a statutory notice.

### 1) Do you support the proposal to:

Reduce the published admission number by 9 places from 54 to 45 from September 2024 and increase the age range from 4-11 to 3-11 by establishing a nursery class at Malpas Church in Wales Primary School with effect from September 2025

Yes  No  In part

Please use the box below to provide comments or explain which element of the proposal you do/do not support.

The Council has a duty to consider and identify all the possible effects a policy decision may have on opportunities for persons to use the Welsh language or treating the Welsh language no less favourably than the English language.

### 2) Do you believe that the proposal will have a positive or negative effect on opportunities to use the Welsh language?

Positive  Negative  No effect

### 3) If you think it will have a negative effect, what steps could we take to lessen or remove this and improve positive effects?

**4) Do you believe that the proposal will treat the Welsh language less favourably than the English language?**

Yes  No

**Please indicate who you are (e.g. parent/carer of a child attending a local nursery)**

--

Please select your Ethnic group			
White British		Asian-Bangladeshi	
White Irish		Asian-Indian	
Any other White background (please state): _____		Asian-Pakistani	
		Any other Asian background	
Gypsy or Irish Traveller		Black Caribbean	
White and Asian		Black African	
White and Black African		Any other Black background	
White and Black Caribbean		Arab	
Any other Mixed background (please state): _____		Chinese	
		Any other ethnic group (please state): _____	
Asian-Bangladeshi		Prefer not to say	
Asian-Indian			
Asian-Pakistani			

Welsh language			
<b>Do you consider yourself a Welsh speaker?</b>			
Yes		No	
			Prefer not to say

Caring Responsibilities			
<b>Do you care for children of school age?</b>			
Yes		No	
			Prefer not to say
<b>Do you care for children of pre-school age?</b>			
Yes		No	
			Prefer not to say
<b>Do you care for a dependent adult or child above school age?</b>			
Yes		No	
			Prefer not to say

If you wish to be notified of the publication of the consultation report, please supply your contact details:

E-mail: \_\_\_\_\_

Postal address: \_\_\_\_\_