

Formal Consultation to increase the capacity and pupil age range of Langstone Primary School

9 September – 29 October 2015



Table of Contents

Introduction	2
The consultation process	2
How do you make your views known?	2
The proposal	4
Nursery Provision	4
Standards	4
Primary Education	5
Demand for places	6
Standards	7
What the proposal will provide	8
Indicative plans	9
Alternative options considered	11
What the proposal will achieve	11
Catchment area	11
Admissions	12
Transport	13
Staffing	13
Advantages/disadvantages	13
Risks	14
Fairness and Equality Impact Assessment	14
Consultation response pro-forma	15





Introduction

The purpose of the consultation is to seek views on the proposal to establish a nursery at Langstone Primary school, increasing the pupil age range from 4-11 to 3-11 years, and also to increase the school capacity from 315 places (1.5 form entry) to 420 places (2 form entry). It is your chance to ask questions and make comments that will be considered when the council decides how to proceed.

Duration of the formal consultation period:

- Begins on Wednesday 9 September 2015
- Ends at midnight on Thursday 29 October 2015

The proposal

To establish a 24 place nursery class at Langstone Primary school, in line with the council’s strategy to provide a Local Authority maintained nursery class for three to four year-olds within each community maintained school. This will increase the number of funded nursery places available across the city, to enable positive transition into statutory mainstream education.

To increase the capacity of Langstone Primary school from 315 to 420 pupil places. This will be achieved by removing three temporary classrooms currently in use and replacing them with a new build extension to the main school. This will result in an increase in the published admission number (PAN) of the school from 45 to 60.

It is proposed that both changes will take effect from September 2017.

What does the consultation process entail?

The consultation process represents an opportunity for people to learn about the proposal and to ask questions or make comments that will be recorded and summarised in a consultation report. This report will be published on the council’s website and will be considered when the council decides on the way forward.

Should the council decide to proceed with the proposal, a statutory notice will be published providing a 28 day period in which objections to the proposal may be lodged. This is known as the objection period.

The consultation process includes public consultation events at Langstone Primary school which provide an opportunity for members of the public to meet with council officers, discuss the proposal and ask questions. These are drop-in events and the public can attend within the allocated times shown below.

How do you make your views known?

Comments and questions can be submitted using the enclosed response pro forma, by taking our online consultation survey hosted at Newport.gov.uk/haveyoursay or by writing or sending an e-mail to:

Education Business Development Officer, Newport City Council, Civic Centre, Newport NP20 4UR.

E mail: school.reorg@newport.gov.uk

Please note that negative responses made during the consultation period will not be counted as objections to the proposal, but recorded as adverse comments. Objections to a proposal can only be registered during the objection period, following the publication of a statutory notice.

The following consultation events have been arranged. You are welcome to attend and meet council officers face-to-face to discuss the proposal.

Venue	Date & Time	Event type
Langstone Primary School	10 September 2015; 3.45-5.45pm	Drop-in
Langstone Primary School	11 September 2015; 09.00-11.00am	Drop-in



Arrangements for the participation of children and young people

A 'Children's Consultation Questionnaire' has been produced and is available from Langstone Primary School or from Newport City Council.

The council will consult with pupils at Langstone Primary School through the school council, and children and young people are encouraged to attend a drop-in consultation session.

Copies of the Children's Consultation Questionnaire can be requested by e mail: school.reorg@newport.gov.uk; or by telephone: 01633 235341

The deadline for consultation responses is midnight on 29 October 2015

Who will we consult with?

- Teachers, staff and the governing body of Langstone Primary School;
- Parents, carers and guardians of pupils attending Langstone Primary school;
- Pupils at Langstone Primary School;
- Monmouthshire County Council as the neighbouring Local Authority with school catchment areas that border Newport;
- The Church in Wales and Roman Catholic Diocesan Authority for Gwent;
- The Head teacher and governing body of Llanmartin, Ringland, Milton Infants and Junior, St. Gabriel's Roman Catholic, Charles Williams Church In Wales, and Caerleon Lodge Hill primary schools;
- The Head teacher and governing body of Caerleon Comprehensive school;
- The Welsh Ministers;
- Assembly Members (AMs) and Members of Parliament (MPs) representing the area served by any school which is subject to the proposals;
- Estyn;
- Teaching and staff trade unions representing teachers and staff at Langstone Primary School;
- The South East Wales Education Achievement Service;
- Local Authority Transport departments;
- The Police and Crime Commissioner for Gwent;
- Community Councils for Langstone, Penhow, and Llanvaches;
- The local Communities First partnership (or equivalent);
- The five independent childcare providers in Langstone and surrounding catchment areas;
- Newport Early Years Development and Childcare Partnership.





What do you have to consider?

The remainder of the consultation document sets out the rationale for the proposal. We would like you to consider the information contained within the document and to hear your views as to whether or not you support the proposal.

The proposal

The proposal concerns Langstone Primary School, Old Roman Road, Newport NP18 2JU. The proposal is to provide a 24 place nursery classroom through the remodelling of an existing classroom. The three demountable classrooms currently in use are to be replaced with a new build extension which will provide additional classrooms, allowing the capacity of the school to increase to 420 pupils, plus nursery. These works will improve accessibility to the school and provide much improved environments for teaching and learning.

Nursery Provison

This proposal is part of a strategy to realise a 3-11 vision for community maintained primary schools across Newport in order to increase the number of nursery places, and enable positive transition into statutory mainstream education.

Each of the neighbouring community maintained school catchment areas have nursery provision for half-day, morning or afternoon sessions within the school settings. Charles Williams Church in Wales provides a single year nursery education. St. Gabriel's Roman Catholic School does not provide nursery education, although a private non-maintained early years provider operates on that site.

There are five non-maintained early years providers in the Langstone and neighbouring catchment areas. Details of the numbers of funded children on roll and Estyn inspections for these are shown below. It should be noted that these childcare providers have additional children registered for care other than the funded half day placements listed below.

Non-maintained settings in Newport East			
Provider/ setting	Registered Capacity	AM/PM session	No. funded children registered
Langstone Playgroup	24	AM only	15
Babes in the Wood, Llanmartin school	24	AM & PM	10
Little Angels, St. Gabriel's School	24	AM only	30
Osborne Children's nursery	16	Full day care 08:00 – 18:00	21
Caerleon Cherubs	20	Full day care 08:00 – 18:00	21

Standards

Estyn is the office of Her Majesty's Chief Inspector of Education and Training in Wales. It, together with the Care and Social Services Inspectorate Wales (CSSIW) is responsible for inspecting standards in funded nursery provision.

Inspection outcomes for the non-maintained nursery providers in the area are shown overleaf.



Provider/ setting	Inspection date	Outcomes	Provision	Leadership and management
Langstone Playgroup	November 2011	Good	Good	Good
Babes in the Wood, Llanmartin school	January 2012	Good	Good	Good
Little Angels, St. Gabriel's School	March 2011	Good	Good	Good
Osborne Children's nursery	January 2012	Good	Good	Good
Caerleon Cherubs	July 2011	Good	Good	Good

Statutory Primary Education Provision

Langstone primary school was originally built in around 1955 as a single form entry school. Due to the demand for school places, additional temporary classrooms were added in the 1980s, thereby increasing the capacity of the school to 315, making the school 1.5 form entry with a published admission number of 45 pupils.

The school currently provides English language education for 301 children aged between 4 and 11 years in 11 classes. Three of the classes are mixed age classes. There is no nursery provision at the school.

At the January 2014 pupil survey there were only nineteen vacant places across the school, with three of the seven year groups being full. This resulted in ten in-catchment pupils and three out of catchment pupils being refused places at the school during the academic year.

In 2015, the number of pupils on roll has continued to rise. At the time of writing six in-catchment pupils have been refused places in the school this year and have been placed on a waiting list for a place at the school. Applications for admission to reception class for September 2015 are oversubscribed, with fifty two first preference applications received for the school.

There are three new housing developments being created in the catchment area for the school, creating over 130 new houses which will further increase demand for school places at Langstone.

The number of pupils on roll at the school this year and for the last four years is shown below, together with the projected pupil numbers up to 2020.

Pupil populations

The tables below show the past and projected pupil numbers for Langstone and neighbouring English language primary schools. A steady increase in pupils across the schools can be seen since 2011, with the exception of Llanmartin primary school and Milton Infant and Junior schools which show a slight decline in numbers. In 2015 there are a total of 243 surplus places across the schools. By 2020, the number of surplus places across the schools will have fallen to 201, despite plans to expand at Lliswerry Primary School.*

* Newport City Council is not the admissions authority for St. Gabriel's Roman Catholic School or for Charles Williams Church in Wales school. Surplus places in these schools have therefore been omitted in this calculation.





Primary School pupil numbers 2011-2015 R-Yr6 (excluding nursery)

School	Capacity	2011	2012	2013	2014	2015	Surplus places 2015
Langstone	315	289	295	285	296	301	14
St. Gabriel's	182	125	127	136	140	142	40
Milton Infants	264	152	164	166	201	199	65
Milton Junior	260	232	229	213	207	207	53
Ringland	252	187	198	206	260	218	34
Llanmartin	210	180	174	172	178	174	36
Llswerry	525	439	417	410	437	484	41
Charles Williams (Caerleon Endowed)	525	439	417	410	437	458	67

Pupil numbers are January PLASC submission for Reception to Year 6.

Nursery pupil numbers 2011-2015

School	2011	2012	2013	2014	2015
Langstone					
St. Gabriel's	-	-	-	-	-
Milton Infants	84	69	78	83	76
Ringland	23	33	31	34	16
Llanmartin	25	32	27	12	24
Llswerry	71	79	79	78	78
Charles Williams (Caerleon Endowed)	62	61	63	64	70



Primary School pupil projections R-Yr6 (excluding nursery) 2016-2020							
School	Capacity	2016	2017	2018	2018	2018	Surplus places 2020
Langstone	315	302	297	309	319	319	-4
St. Gabriel's	182	151	149	150	153	156	26
Milton Infants	264	201	207	208	200	193	71
Milton Junior	260	213	227	253	252	252	16
Ringland	252	224	229	240	244	246	6
Llanmartin	210	169	170	166	168	165	45
Lliswerry	630*	503	521	537	543	548	82
Charles Williams (Caerleon Endowed)	525	466	473	487	494	496	29

These projections are based on birth rates and do not include the anticipated impact of new housing developments.
 *The capacity of Lliswerry Primary School is being increased to 630 from September 2016.

Standards

Quality and standards in schools in Newport are monitored by Estyn and the Local Authority. Estyn is the office of Her Majesty's Chief Inspector of Education and Training in Wales. The inspection outcomes for the schools are shown below. Copies of the Estyn report for each school can be found at www.estyn.gov.wales.

School	Inspection date	Outcomes	Provision	Leadership and management	Overall Summary	
					Performance	Prospects for Improvement
Langstone	June 2014	Excellent	Good	Excellent	Excellent	Excellent
St. Gabriel's	September 2011	Good	Good	Good	Good	Good
Milton Infants	November 2013	Excellent	Excellent	Excellent	Excellent	Excellent
Milton Junior	November 2010	Excellent	Excellent	Excellent	Excellent	Excellent
Ringland	November 2010	Good	Good	Good	Good	Good
Caerleon Endowed Junior*	June 2012	Good	Good	Adequate	Good	Adequate

*This school became Charles Williams Church in Wales Primary School in September 2014

The Estyn inspection framework was changed in 2010. The following table shows the inspection outcomes for the schools that were inspected under the previous framework which focused on seven Key Questions and attributed grades from one (Good with outstanding features) to five (Many important shortcomings):



School	Inspection Date	KQ1	KQ2	KQ3	KQ4	KQ5	KQ6	KQ7
Llanmartin	March 2009	2	2	2	2	2	2	2
Lliswerry	May 2010	1	1	1	1	1	1	1
Caerleon Endowed Infants	May 2010	2	2	2	2	2	2	2

KQ1: How well do learners achieve? KQ2: How effective are teaching training and assessment? KQ3: How well do the learning experiences meet the needs and interests of learners and the wider community? KQ4: How well are learners cared for, guided and supported? KQ5: How effective are leadership and strategic management? KQ6: How well do leaders and managers evaluate and improve quality and standards? KQ7: How efficient are leaders and managers in using resources?

Langstone Primary School has been above the median in its Free School Meals (FSM) benchmarking group for the last three years in pupils achieving the Foundation Phase expected outcome (age 7) and for those achieving the expected level – Core Subject Indicator at Key Stage 2 (age 11).

The South East Wales Education Achievement Service has placed the school in the green colour coded support category (in the range green, yellow, amber, red). This indicates that the school is considered to be highly effective with strong leadership.

Attendance at the school is slightly above the FSM group median at 96.1% (2014).

The council believes that the proposal will have a positive impact on the quality of education outcomes and provision in the area. The addition of a nursery class will provide quality early years education and improve learner transition, through effective curriculum continuity in the foundation phase and into key stage two.

Building condition

The buildings at Langstone primary school were inspected as part of the 21st Century Schools surveys in 2010. The school was judged to be in condition C overall, on a scale of A (excellent) to D (poor), with the three demountable classrooms being in poor condition.

The backlog maintenance value for the school is estimated at £430,000.

School	Condition grade
Langstone	C
St. Gabriel's	C
Milton Infants	C
Milton Junior	C
Ringland	B
Llanmartin	B
Lliswerry	B
Charles Williams (Caerleon Endowed)	C

Source: 21CS schools condition survey, 2010 – grades allocated on scale A - D



What the Proposal will provide

The proposal is to replace three demountable classrooms with an eight classroom new build extension. This will provide five additional classrooms, one of which will allow for the relocation of pupils to provide a nursery class and another will enable an existing junior classroom to be remodelled to provide a staffroom suitable for this size school. The new extension to the school will provide the following:

Ground Floor

- 2x year 3 classrooms with store cupboard
- 2x year 4 classrooms with store cupboard
- Year 3 and year 4 cloakrooms
- Boys and girls toilets
- Accessible toilet
- Lift

First floor:

- 2x year 5 classrooms with store cupboard
- 2x year 6 classrooms with store cupboard
- Year 5 and year 6 cloakrooms
- Boys and girls toilets
- Accessible toilet
- Lift

The proposal will enable the school to provide education for up to 420 3-11 year-old children in 14 single-age classes, plus one nursery class of 24 full time equivalent places.

An impression of what the new extension layout could look like is shown below.

Fig.1 – Indicative extension drawing
(Ground floor and first floor)

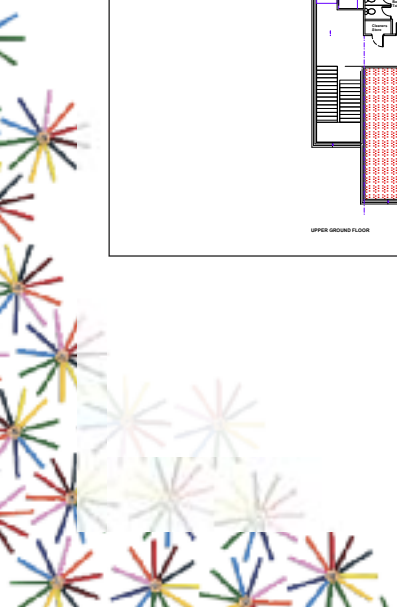
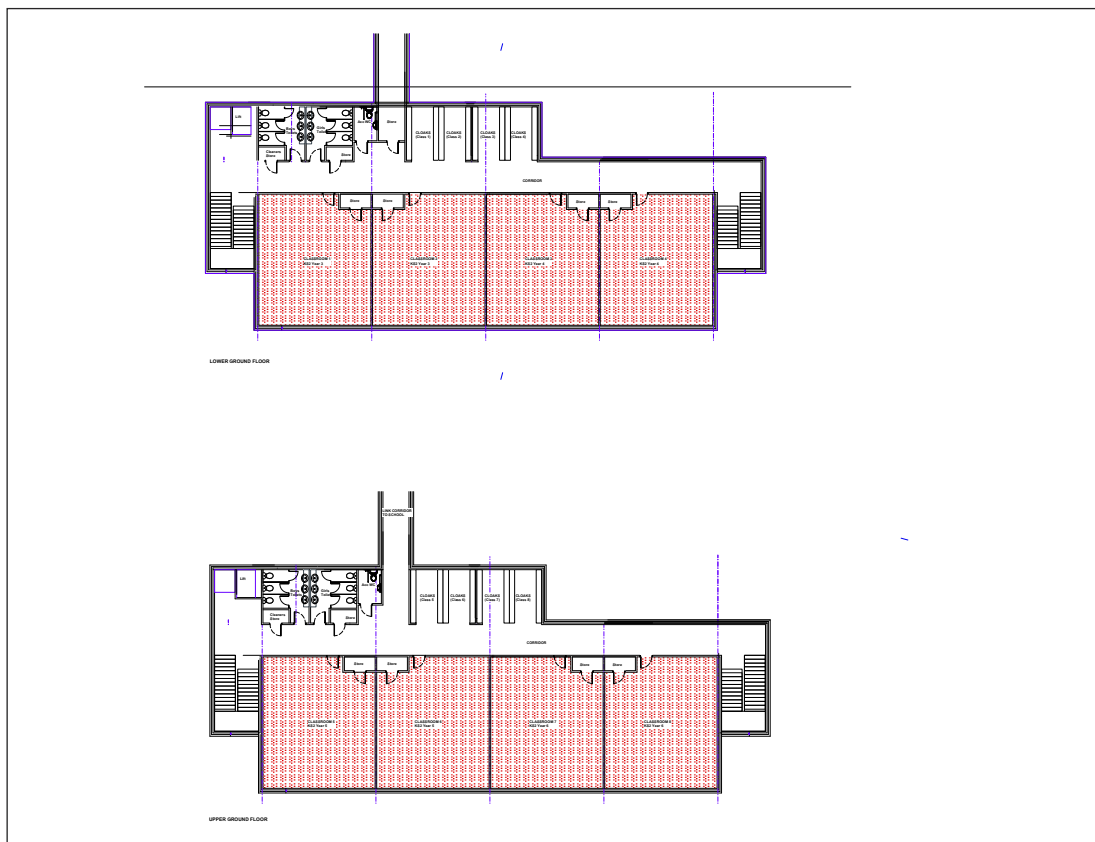



Where –

The new extension will be situated to the south east of the existing school building and will be linked to the existing building by a corridor.

Fig.2 – Indicative site plan

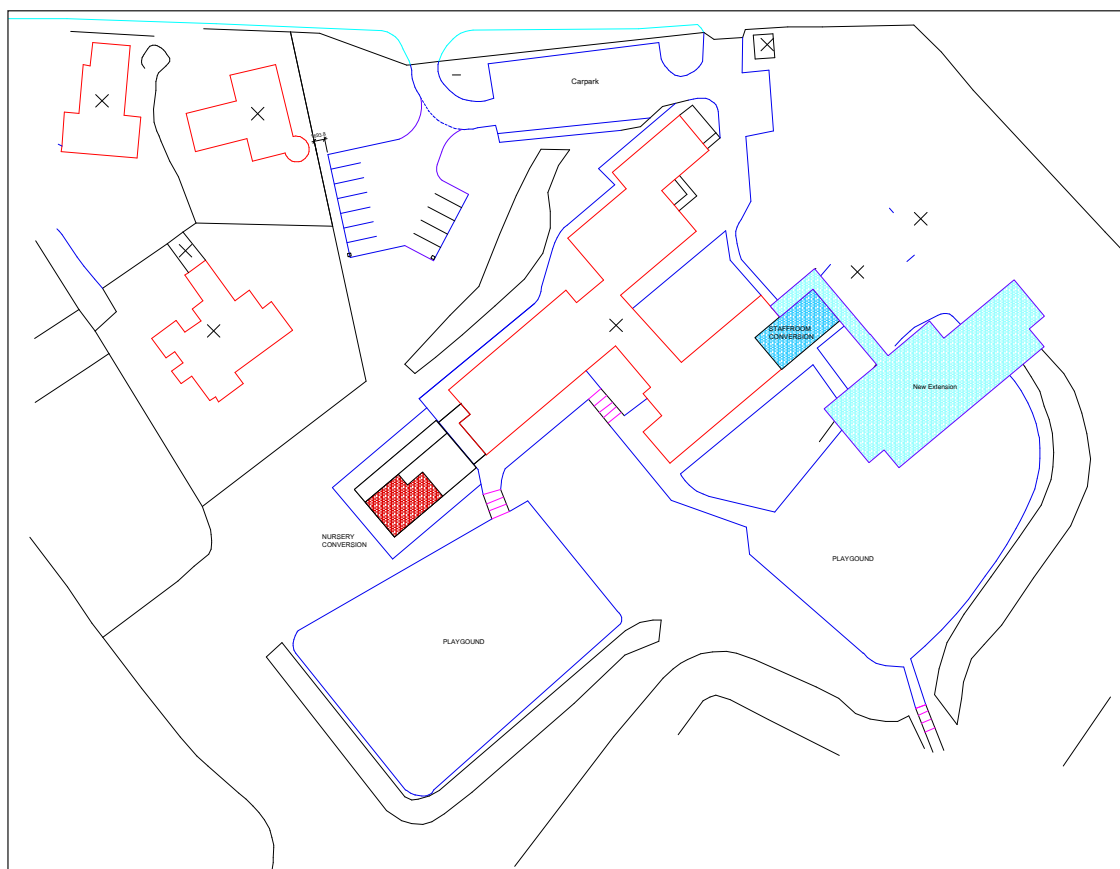

When

It is proposed that the works will be completed to allow the nursery to open and for the admission number to be raised to 60 for September 2017.

Cost

The budget for the project is circa £2.25m.

This is a combination of Newport City Council capital investment and Welsh Government match funding through the 21st Century Schools and Education Programme, together with S106 monies received by Newport City Council, from developers, to supply school places in the area.

This can be presented as a cost of £4,978 per pupil place.

The additional staffing costs due to the increased pupil population of the school are anticipated to be in the region of £500,000 per annum, once the school is full.

There will be no additional transport costs incurred as a result of this proposal.



Alternative Options Considered

Do Nothing - Langstone Primary School would remain a 1.5 form entry school for pupils aged from 4-11 years. As the school is unable to provide sufficient places to meet demand there will be a likely increase in the number of admissions appeals for the Local Authority to consider. Many parents will be unable to secure a place in the school of their choice and the Local Authority will have to fund transport for the children to another school. The S106 monies due to the council from the new developments in the catchment area will not be paid to the council, and demand for school places will have to be absorbed by other schools.

There is no initial capital outlay required for the do nothing option. However, there will be an ongoing transport cost associated with admitting children to more distant schools and the cost of processing and hearing admission appeals will also be borne by the council.

The table on page 7 shows that only two non-denominational schools in the area are forecast to have any significant number of places by 2020: Llanmartin Primary School and Lliswerry Primary School which are situated 2.4 and 5 miles away respectively. Llanmartin is the nearest neighbouring school and will have some surplus places, but not enough to accommodate the anticipated demand generated by the new developments in the Langstone catchment area.

Lliswerry Primary School is also forecast to have a number of surplus places by 2020, however the school is located five miles from Langstone and diverting children to this school would have cost implications in terms of transport and admissions appeals. The Council would also be unable to claim the S106 monies referred to above.

This option would do nothing to improve the condition of the three demountable classrooms on site at Langstone. In due course these will need to be replaced at a cost of approximately £600,000 which would require an alternative funding source.

Expand another school – The nearest school in the area that could be expanded is Llanmartin. However, expanding this school would still result in the loss of available S106 monies and would fail to address the problem of the poor condition demountable classrooms on site at Langstone. The demand for places in the area is for Langstone Primary School.

Expand the age range and capacity of Langstone Primary School – This is identified as the preferred option and the benefits of the proposal are summarised below:

What will the proposal achieve?

The proposal will replace poor condition demountable classrooms with a modern new extension, providing improved learning environments for pupils at Key Stage 2. It will also allow for the addition of a nursery class, providing additional funded nursery education places for the area. The increased capacity of the school will provide sufficient school places for the forecast increase in school age children in the area, and the additional demand resulting from the new housing developments within the catchment area. This will allow more pupils to access the positive learning experiences and outcomes provided at the school.

Catchment area

The Langstone Primary School catchment area is shown below. There is no intention to change the catchment area.



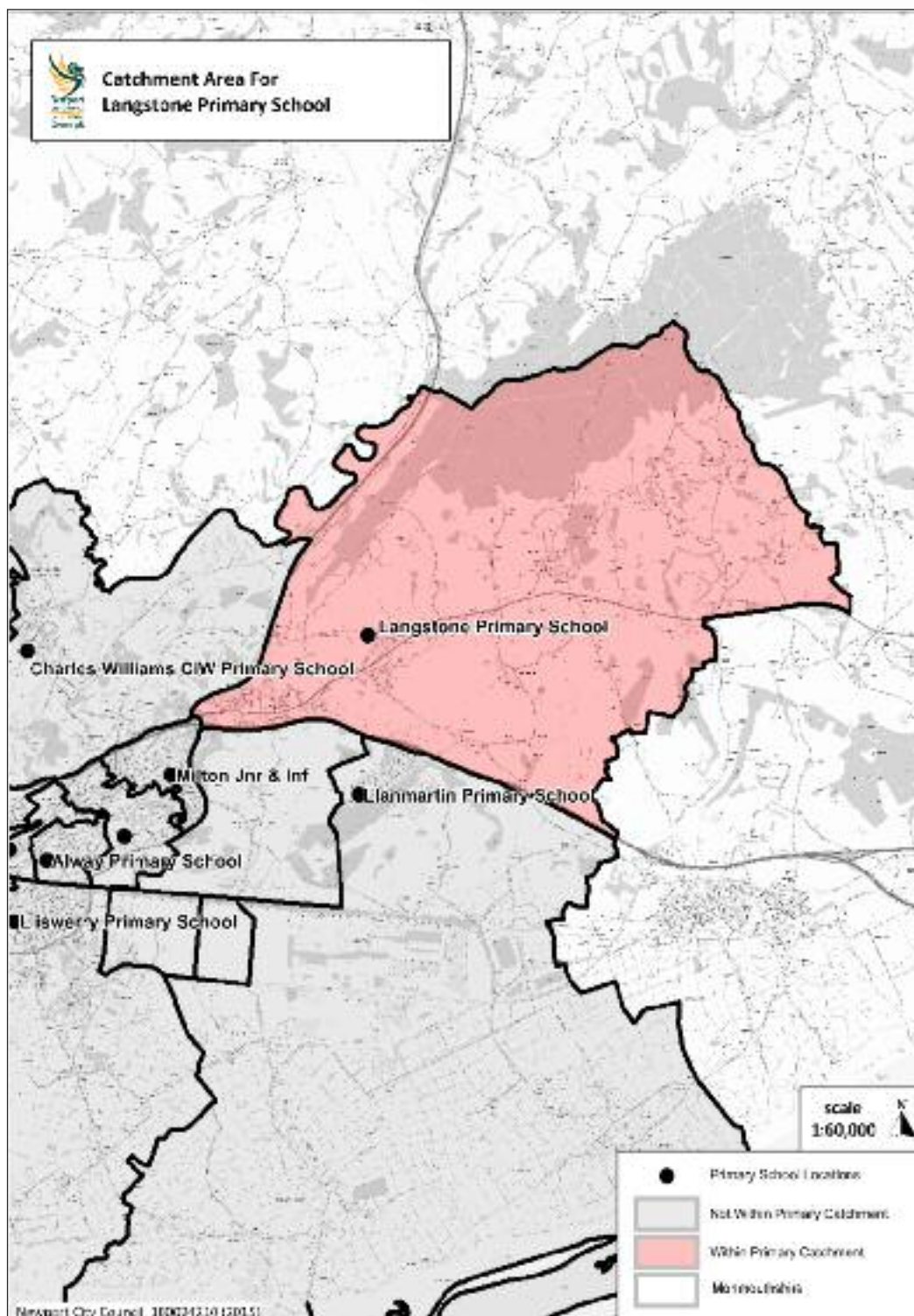

Admissions

Newport City Council will be the admissions authority for the school and the nursery. Information on how to apply for nursery places can be found on the council website at www.newport.gov.uk/nurseryplaces

Information on how to apply for primary school places can be found at www.newport.gov.uk/schooladmissions

All children resident in Newport are entitled to a free part-time education place in the term after their third birthday. This place can be in a council nursery school/class or in a non-maintained setting, which may be a playgroup or a private day nursery. The council does not deal with applications to registered education provider settings, and enquiries regarding these should be made directly to the provider in the first instance.

This will enable an effective, affordable and accessible model for wrap around childcare in the community, delivered in partnership with the non-maintained sector.

The council actively discourages the practice of parents registering their child's name at a specific school often sometime in advance of the application timetable. There is no role for Headteachers in the allocation of nursery places as this is the sole responsibility of the council. In schools where nursery applications are in excess of the number of places available, the council will apply its oversubscription criteria to allocate places. Admission to nursery schools and classes is for a 'half-day' session, either morning or afternoon, five days per week.

The allocation of morning and afternoon places is the responsibility of the Headteacher of the relevant school. The council is unable to consider applications for only part of a school week.

Transport

Free home to school transport is provided to primary aged pupils who live more than two miles from their catchment school or nearest available school. Funded transport is not provided for nursery age children.

The increase in the capacity of the school will potentially result in some increase in the volume of traffic in and around the school site. This is being considered within the design process and an assessment of the impact of increased traffic, and the necessary measures to accommodate this will be submitted with the planning application, for consideration by the highways department.

Staffing

As the occupancy of the school grows, it will be necessary to appoint additional teachers and classroom assistants. By the time the school is full, there will be a need for four additional teachers and four additional classroom assistants.

Advantages/disadvantages

The advantages of this proposal are:

- Additional funded nursery places in the area
- Helps to meet demand for preschool places
- Safe and reliable educational setting
- Introduces children to the school environment from three years of age
- Improved transition into school
- Well established leadership team
- Effective delivery of foundation phase and KS2 education
- Provision of affordable and accessible wrap around childcare
- Additional choice for parents regarding where their child accesses their early years entitlement in the term following their third birthday
- Additional sessions offered to rising threes than can be offered currently
- Enhanced capacity to meet increasing demand for school places
- Provision of high quality education and positive outcomes
- Greater parental choice for primary education
- Fewer admission refusals and appeals

The disadvantages of this proposal are:

- The new extension will occupy some space currently used for playground
- There is likely to be some increase in drop-off and pick-up traffic at the beginning and end of the school day.
- There will disruption on site and restricted access during the build programme

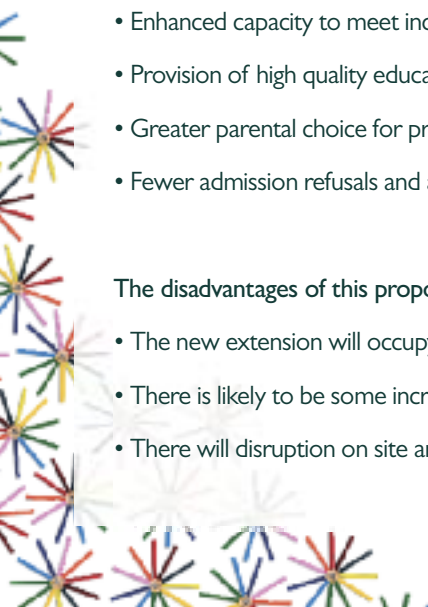



The risks associated with this proposal, and mitigating factors are listed below:

Risk	Mitigating factor
The new nursery provision may have an adverse effect on numbers attending non-maintained settings	The only non-maintained setting in the catchment area provides morning only playgroup and currently has only 15 funded child places. Reception Class at Langstone Primary currently admits 45 pupils and is oversubscribed. This indicates a shortage of childcare provision in the area. It is not therefore expected that the proposal will have an adverse effect on non-maintained provision.
There may not be enough demand for the nursery places created to be taken up	As above, There is evidence of a demand for nursery places. It is expected that the new provision will help meet this demand.
The additional pupils will result in additional traffic and parking issues	Additional parking spaces will be provided as part of the project. However it is acknowledged that traffic will need to be effectively managed on the site. A travel plan will be submitted with the planning application and the school will consider start and finish times for the nursery to minimise traffic impact
Creating additional capacity at Langstone could impact the number of children attending other schools nearby	The expansion of the school is intended to address a demand generated from within the catchment area, and these children will be given priority of admission, although the school does receive applications from out-of-catchment households. There is no intention to affect pupil numbers at other schools. The Council and the South East Wales Education Achievement Service supports all schools in their improvement journeys.
Disruption and potential safety issues during the construction period.	There will inevitably be some disruption while the building work is completed. This work will be timetabled to minimise disruption and appropriate safety measures will be taken to ensure pupil safety at all times.

Impact assessments

A fairness and equalities impact assessment has been conducted for this proposal and is available on the council website.



Consultation Response Pro-Forma

- Addition of nursery provision and increased capacity at Langstone Primary School

Your views matter. Please tell us what you think about the proposal by completing this questionnaire and returning it to:
Education Business Development Officer, Newport City Council, Room 425W, Civic Centre, Newport NP20 4UR

Or you can complete and submit this form online through the council website:
www.newport.gov.uk/have_your_say

The closing date for the submission of responses to this consultation is:
Midnight, October 29 2015.

Please note that negative responses made to this consultation will not be counted as objections to the proposal, they will be recorded as adverse comments. Objections can only be registered following the publication of a statutory notice.

Do you support the proposal to establish a new nursery class and to increase the capacity of Langstone Primary School?

Yes

No

Please use the box below to give any reasons or comments (including alternative options).

Please indicate who you are (e.g. parent/carer of a pupil at an affected school)

If you wish to be notified of the publication of the consultation report, please supply your contact details:

e-mail: _____

Postal address: _____

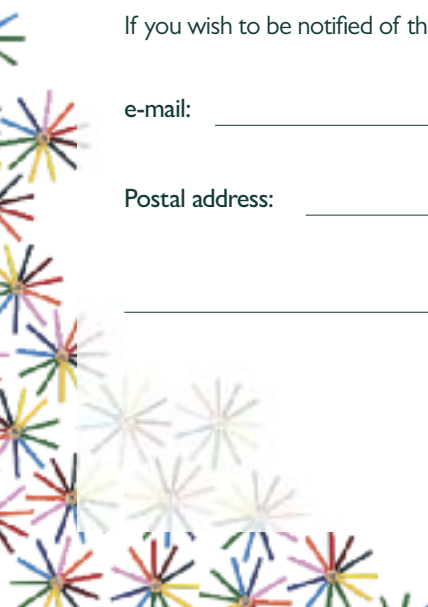

CUT OR TEAR ALONG DOTTED LINE