

LOWER DOCK STREET TOWNSCAPE HERITAGE INITIATIVE  
PREFERRED ARCHITECTURAL DETAILS

Head of Planning and Economic Regeneration

Civic Centre  
Newport  
South Wales

Telephone 01633 232163



Newport  
COUNTY BOROUGH  
BWRDEISTREF SIROL  
Casnewydd

## CONTENTS

SASH WINDOW TYPICAL ELEVATIONS  
SASH WINDOW TYPICAL JAMB SECTION  
SASH WINDOW TYPICAL HEAD SECTION  
SASH WINDOW TYPICAL MEETING RAILS & GLAZING BAR SECTIONS  
SASH WINDOW TYPICAL CILL SECTION  
SASH WINDOW TYPICAL HORN SECTION  
3 PANEL DOOR TYPICAL ELEVATION PLAN & SECTION  
3 PANEL DOOR TYPICAL FANLIGHT HEAD SECTION  
3 PANEL DOOR TYPICAL TRANSOME SECTION  
3 PANEL DOOR TYPICAL TOP RAIL SECTION  
3 PANEL DOOR PANEL & MOULDING SECTION  
3 PANEL DOOR TYPICAL MID RAIL SECTION  
3 PANEL DOOR TYPICAL BOTTOM RAIL SECTION  
4 PANEL DOOR TYPICAL ELEVATION PLAN & SECTION  
4 PANEL DOOR TYPICAL FANLIGHT HEAD SECTION  
4 PANEL DOOR TYPICAL TOP RAIL & TRANSOME SECTION  
4 PANEL DOOR TYPICAL DOOR MIDDLE RAIL SECTION  
4 PANEL DOOR TYPICAL BOTTOM RAIL SECTION  
4 PANEL DOOR TYPICAL JAMB & STILE SECTION  
4 PANEL DOOR TYPICAL MUNTIN SECTION  
DOLPHIN STREET TYPICAL HOUSE ELEVATION  
SOUTH MARKET STREET TYPICAL HOUSE ELEVATION

Head of Planning and Economic Regeneration

Civic Centre  
Newport  
South Wales

Telephone 01633 232163



Newport  
COUNTY BOROUGH  
BWRDEISTREF SIROL  
Casnewydd

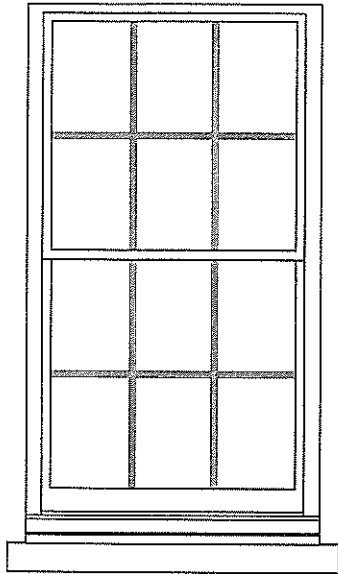

6 OVER 6  
NO HORNS

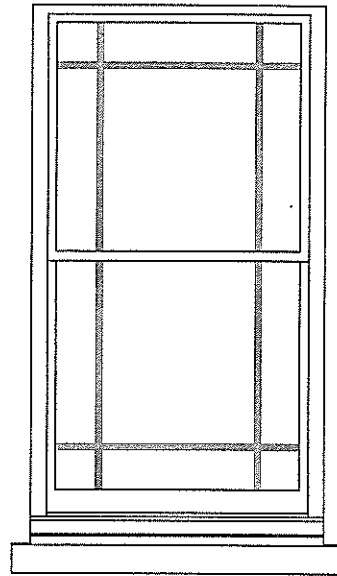

MARGIN LIGHTS  
NO HORNS

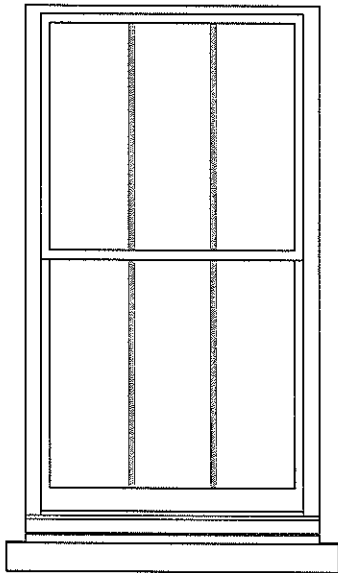

3 OVER 3  
NO HORNS

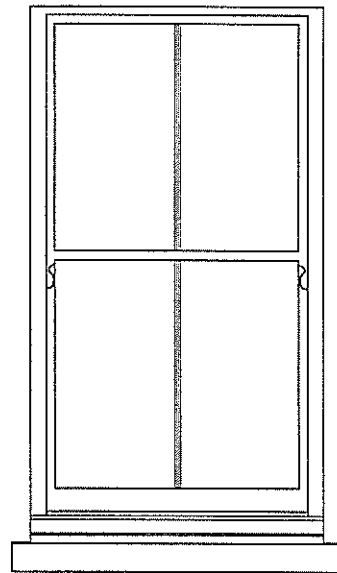

2 OVER 2  
WITH HORNS

OVERALL SIZES SHALL MATCH THE ORIGINAL STRUCTURAL OPENINGS.  
VERIFY THAT THE STRUCTURAL OPENINGS ARE ORIGINAL BEFORE MANUFACTURE.

SASH WINDOW  
TYPICAL ELEVATIONS

1/20 SCALE

Head of Planning and Economic Regeneration

Civic Centre  
Newport  
South Wales

Telephone 01633 232163



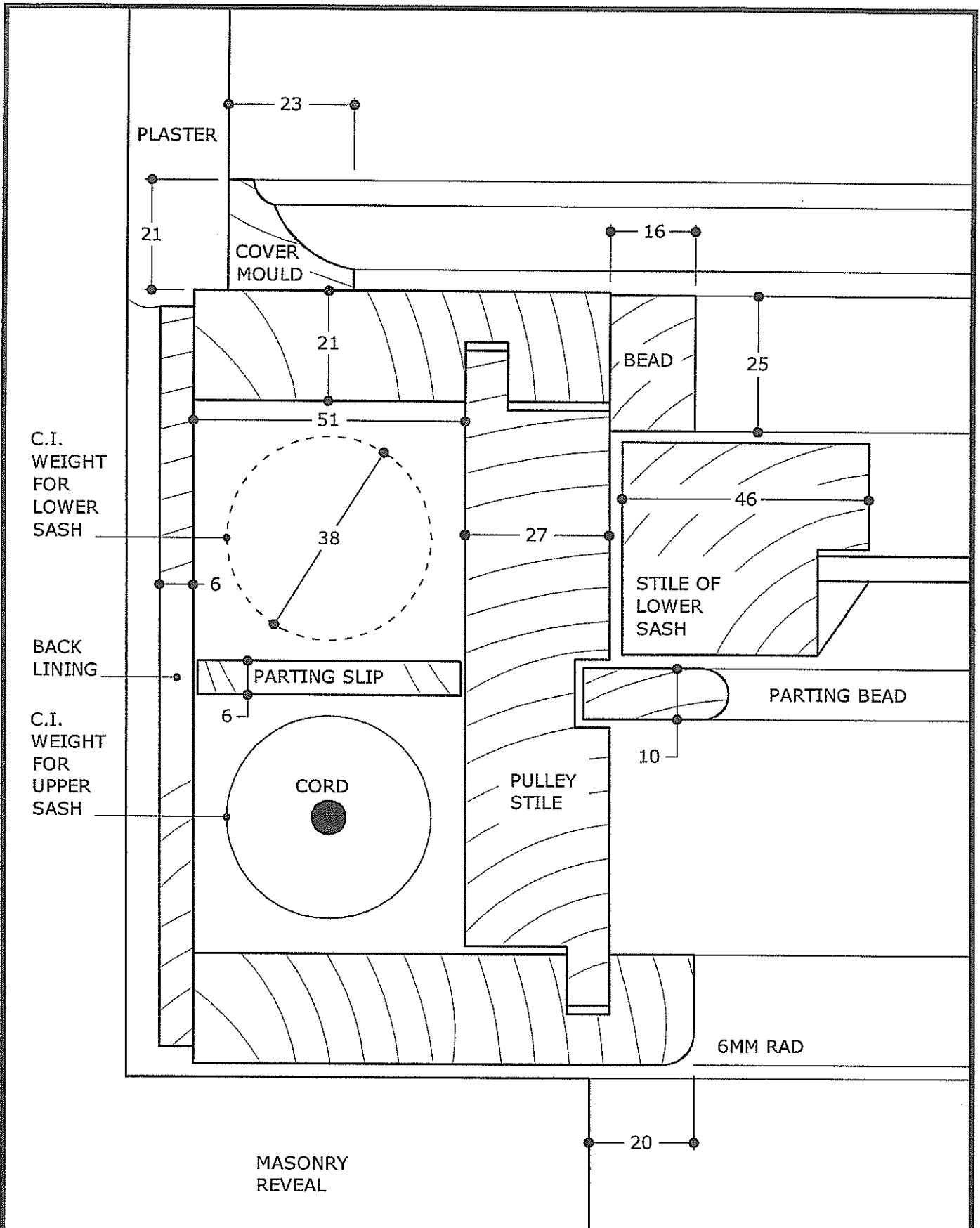

SASH WINDOW  
TYPICAL JAMB SECTION

FULL SIZE

Head of Planning and Economic Regeneration

Civic Centre  
Newport  
South Wales

Telephone 01633 232163



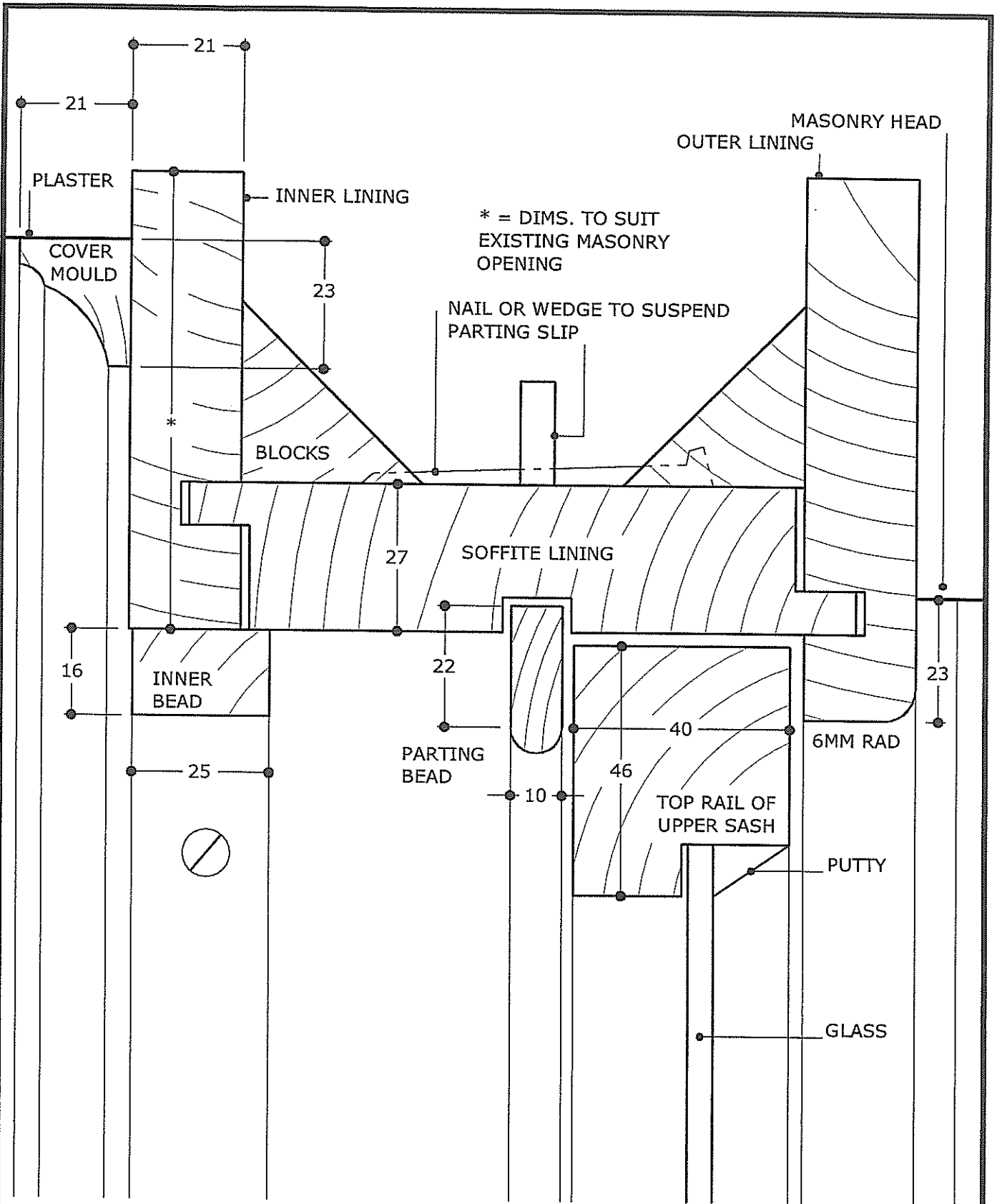

SASH WINDOW  
TYPICAL HEAD SECTION

FULL SIZE

Head of Planning and Economic Regeneration

Civic Centre  
Newport  
South Wales

Telephone 01633 232163



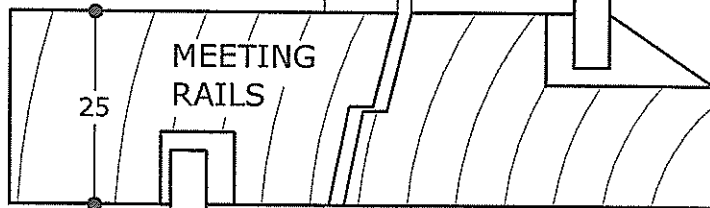

LAMB'S  
TONGUE  
GLAZING  
BAR  
MOULDING

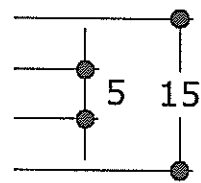
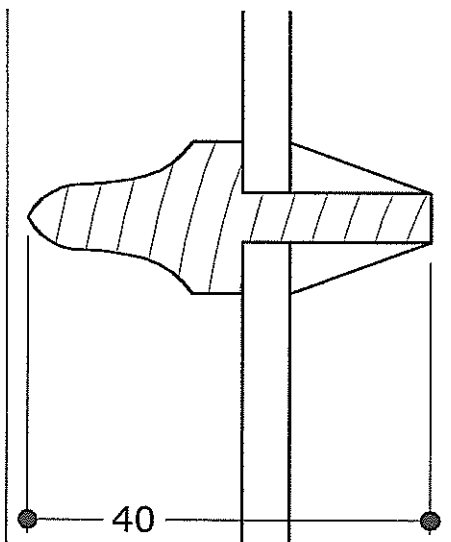

SASH WINDOW  
TYPICAL MEETING RAILS  
& GLAZING BAR SECTIONS  
FULL SIZE

Head of Planning and Economic Regeneration  
Civic Centre  
Newport  
South Wales  
Telephone 01633 232163



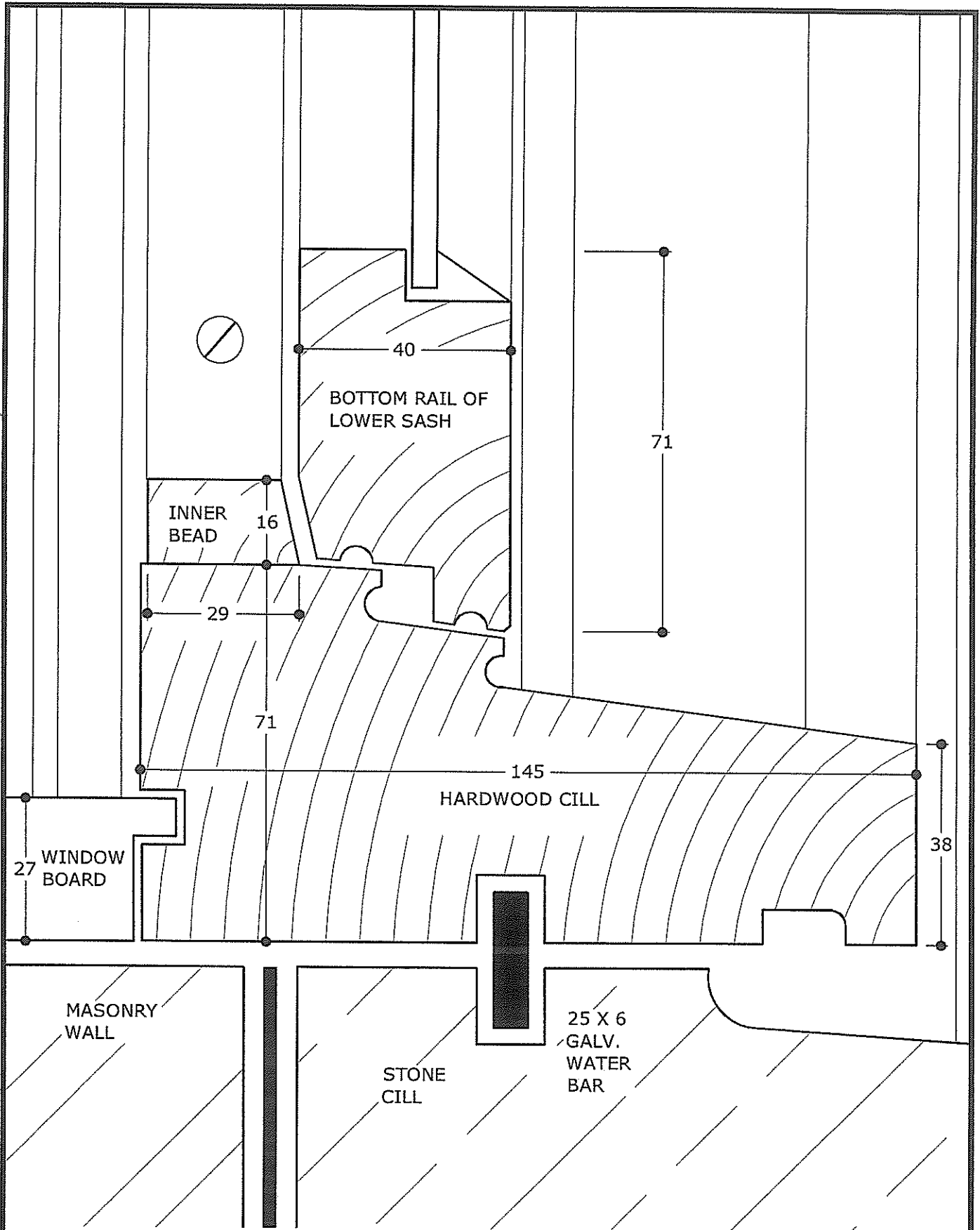

SASH WINDOW  
TYPICAL CILL SECTION

FULL SIZE

Head of Planning and Economic Regeneration

Civic Centre  
Newport  
South Wales

Telephone 01633 232163



Newport  
COUNTY BOROUGH  
DYMAESTRIF SIROL  
Casnewydd

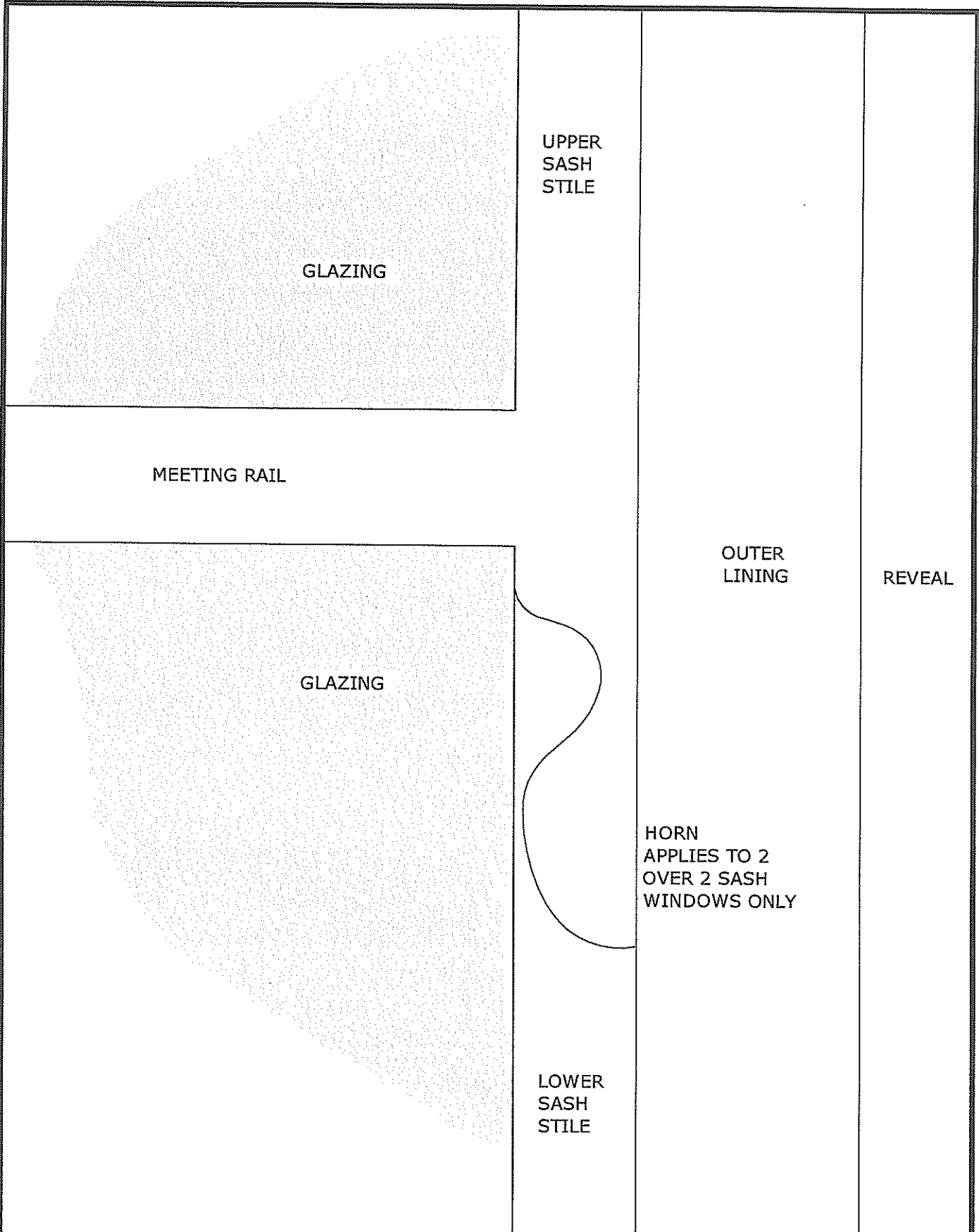

SASH WINDOW  
TYPICAL HORN DETAIL

FULL SIZE

Head of Planning and Economic Regeneration

Civic Centre  
Newport  
South Wales

Telephone 01633 232163





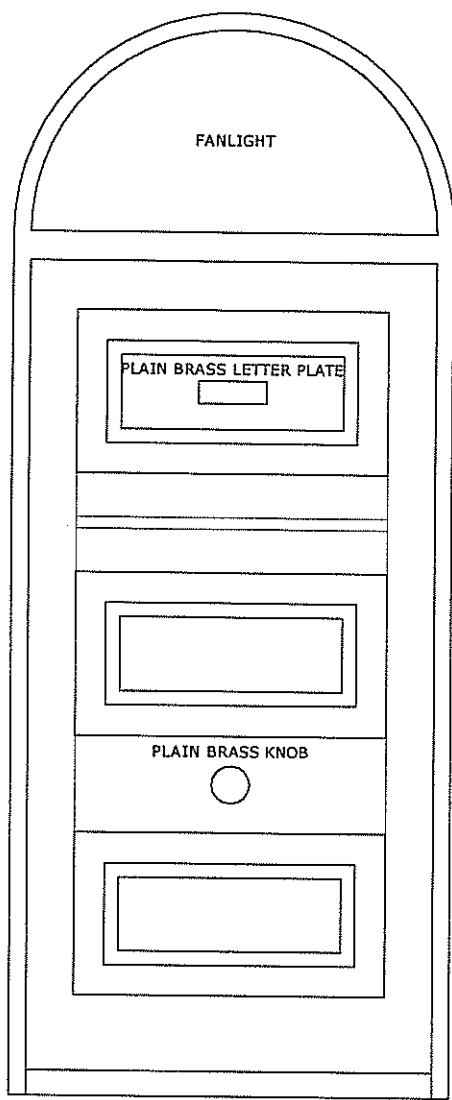

ELEVATION

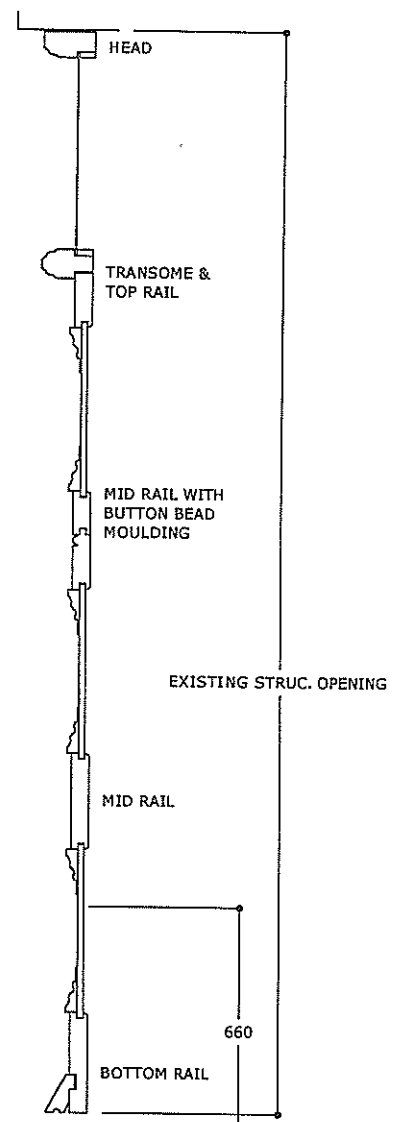

SECTION

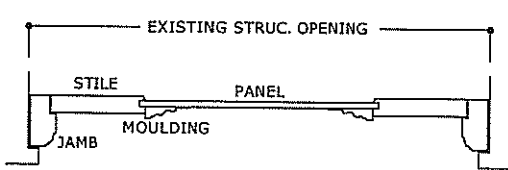

PLAN

3 PANEL DOOR  
 TYPICAL ELEVATION PLAN  
 & SECTION  
 1/20 SCALE

Head of Planning and Economic Regeneration  
 Civic Centre  
 Newport  
 South Wales  
 Telephone 01633 232163



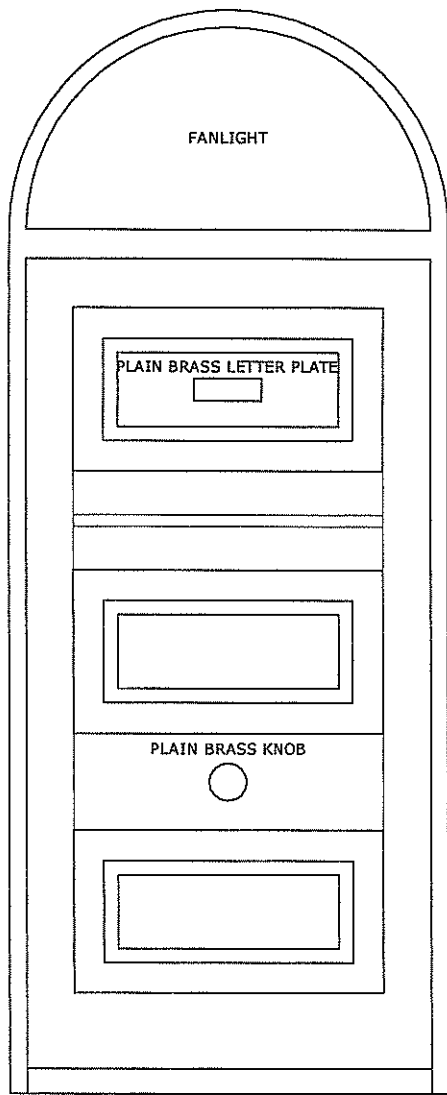

ELEVATION

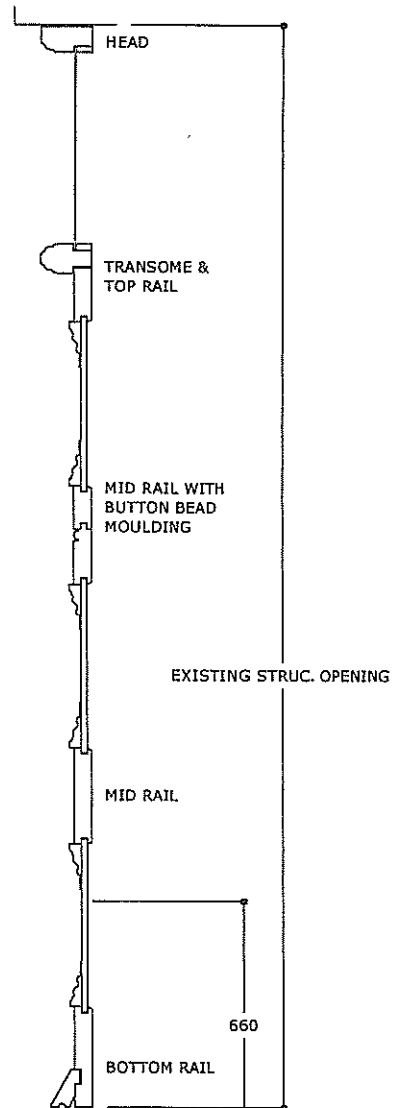

SECTION

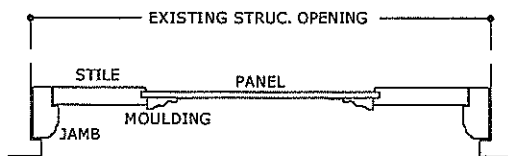

PLAN

3 PANEL DOOR  
TYPICAL ELEVATION PLAN  
& SECTION

1/20 SCALE

Head of Planning and Economic Regeneration

Civic Centre  
Newport  
South Wales

Telephone 01633 232163



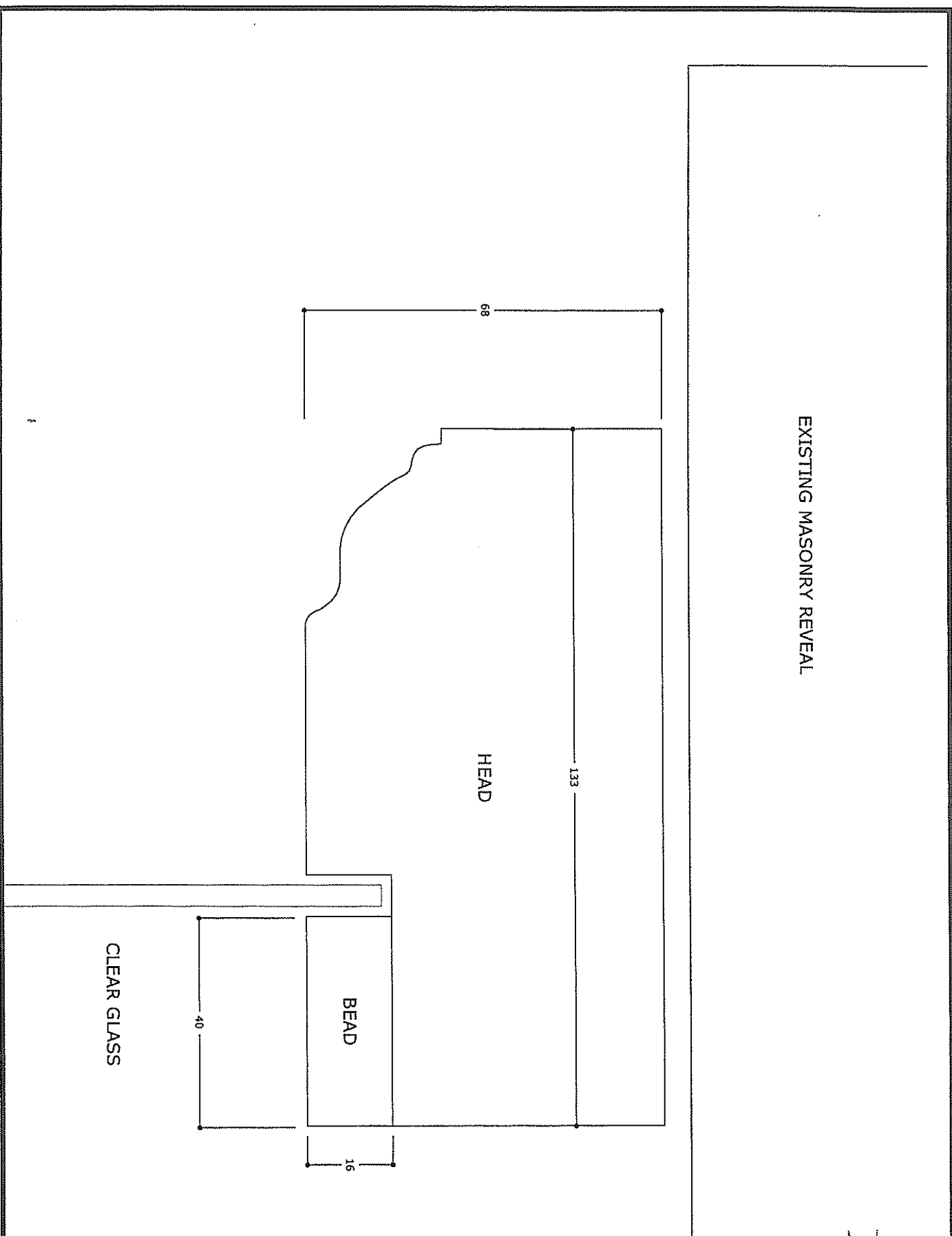

3 PANEL DOOR  
TYPICAL FANLIGHT HEAD SECTION

FULL SIZE

Head of Planning and Economic Regeneration

Civic Centre  
Newport  
South Wales

Telephone 01633 232163

EXISTING MASONRY REVEAL



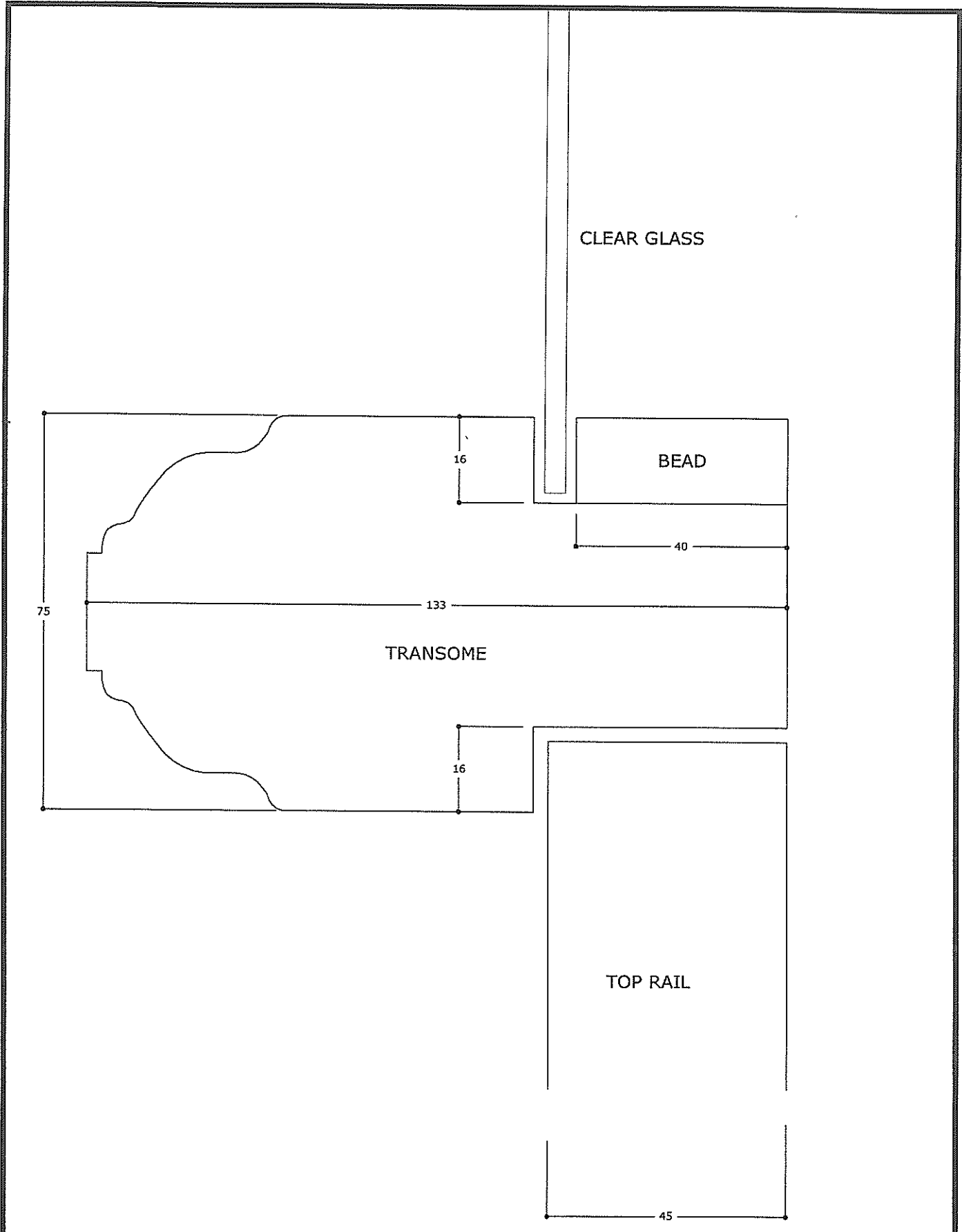

3 PANEL DOOR  
 TYPICAL DOOR TRANSOME  
 SECTION  
 FULL SIZE

Head of Planning and Economic Regeneration  
 Civic Centre  
 Newport  
 South Wales  
 Telephone 01633 232163



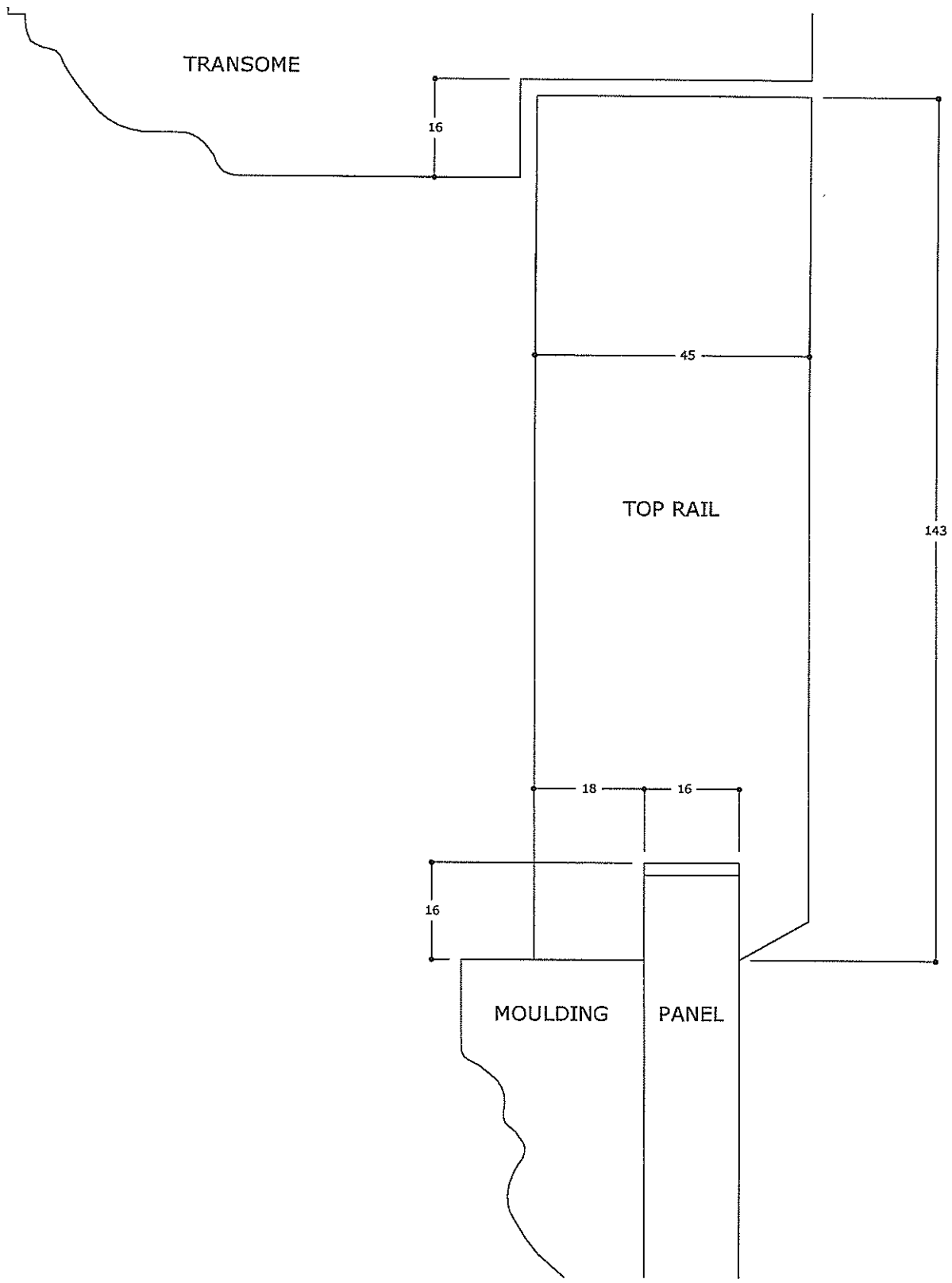

3 PANEL DOOR  
 TYPICAL TOP RAIL  
 SECTION  
 FULL SIZE

Head of Planning and Economic Regeneration  
 Civic Centre  
 Newport  
 South Wales  
 Telephone 01633 232163



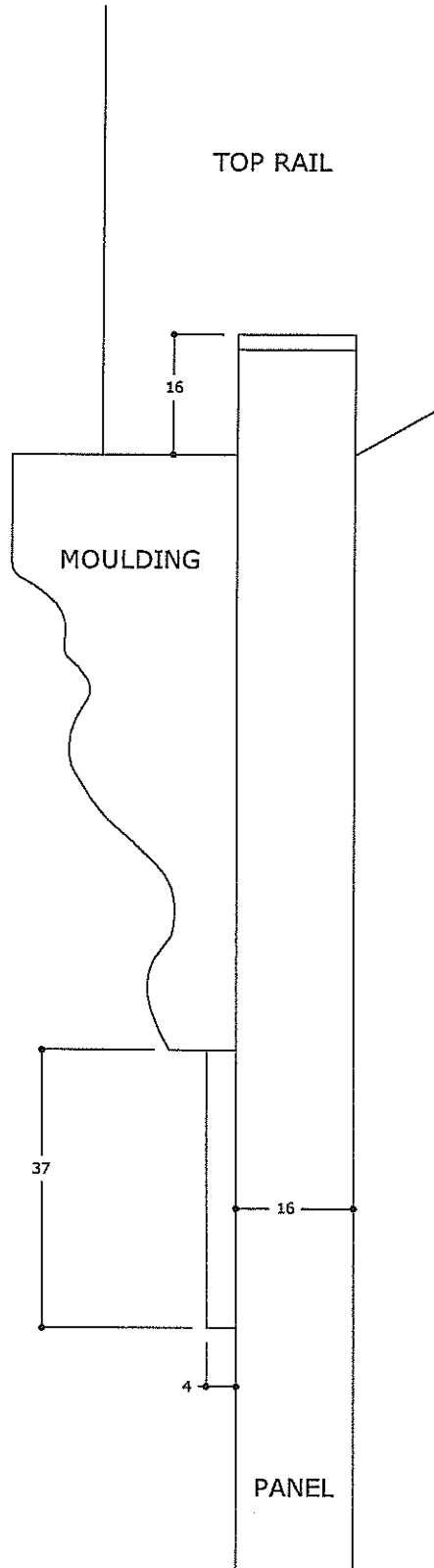

3 PANEL DOOR  
 PANEL & MOULDING  
 SECTION  
 FULL SIZE

Head of Planning and Economic Regeneration  
 Civic Centre  
 Newport  
 South Wales  
 Telephone 01633 232163



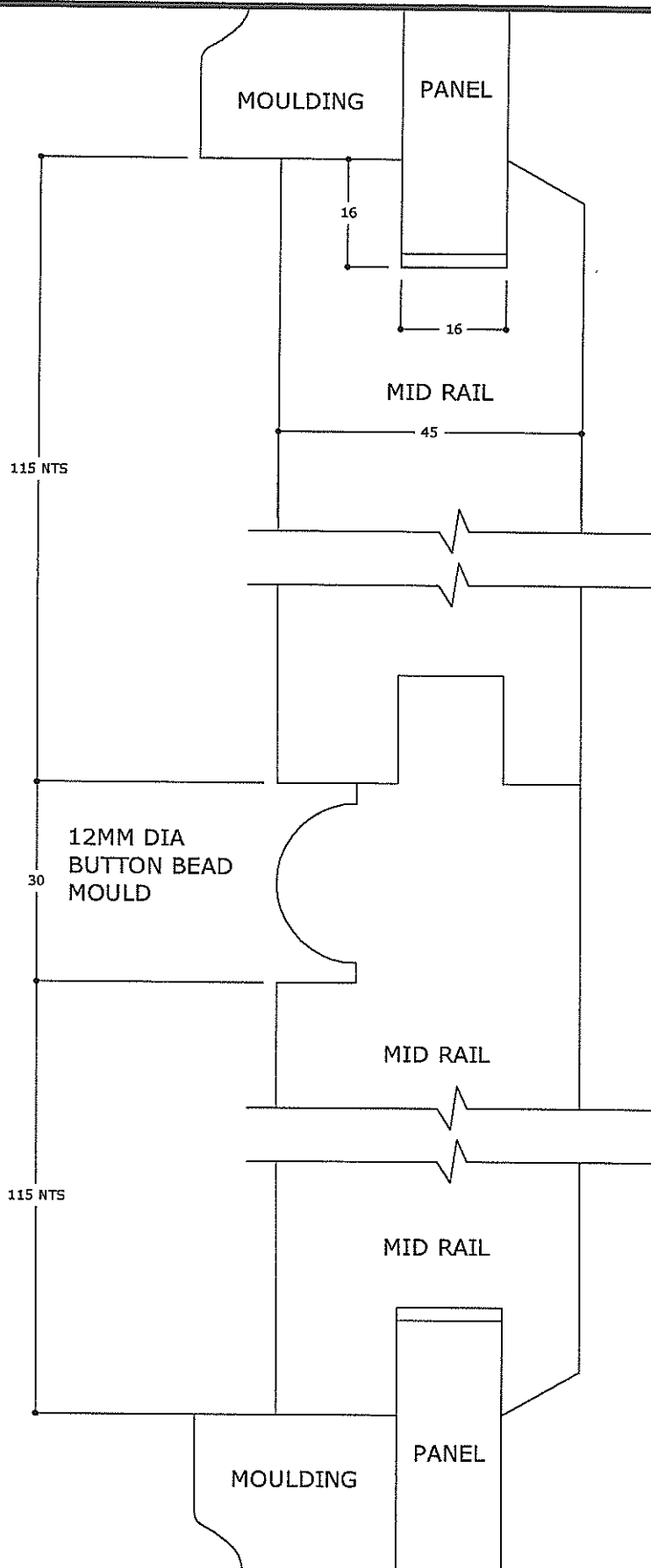

3 PANEL DOOR  
TYPICAL MID RAIL  
SECTION

FULL SIZE

Head of Planning and Economic Regeneration

Civic Centre  
Newport  
South Wales

Telephone 01633 232163



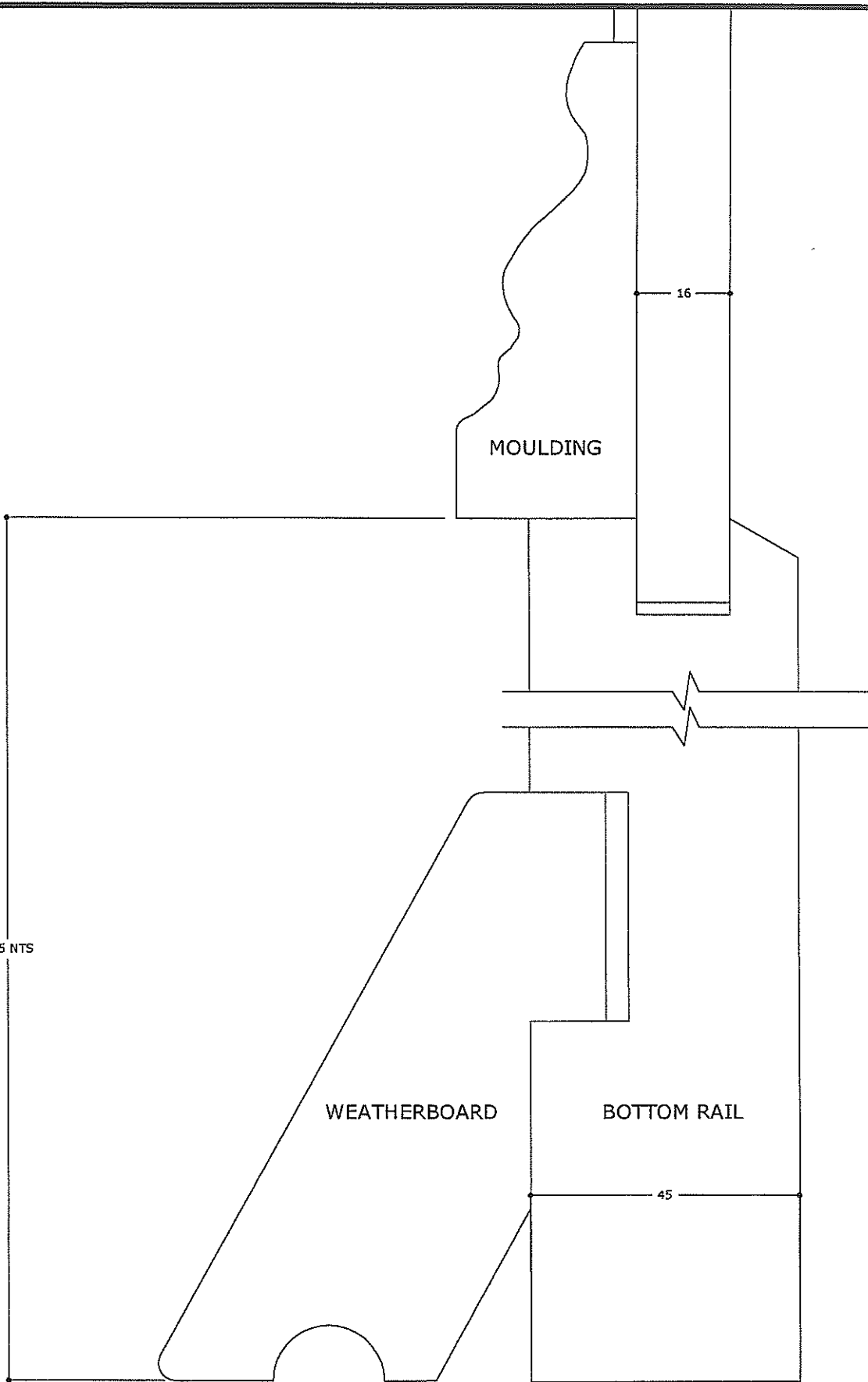

3 PANEL DOOR  
 TYPICAL BOTTOM RAIL  
 SECTION  
 FULL SIZE

Head of Planning and Economic Regeneration  
 Civic Centre  
 Newport  
 South Wales  
 Telephone 01633 232163





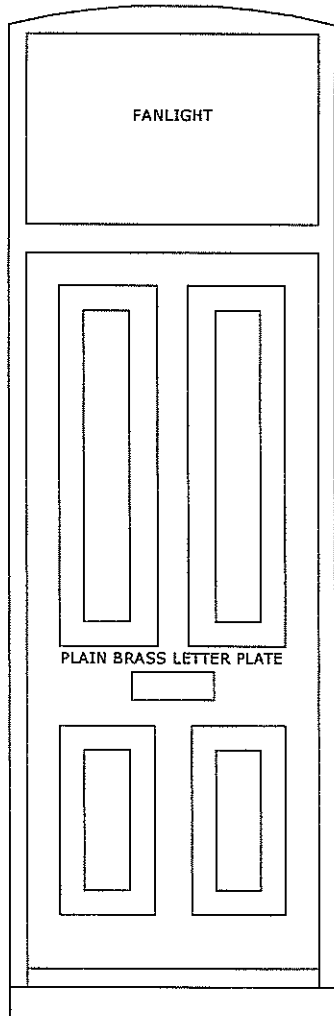

ELEVATION

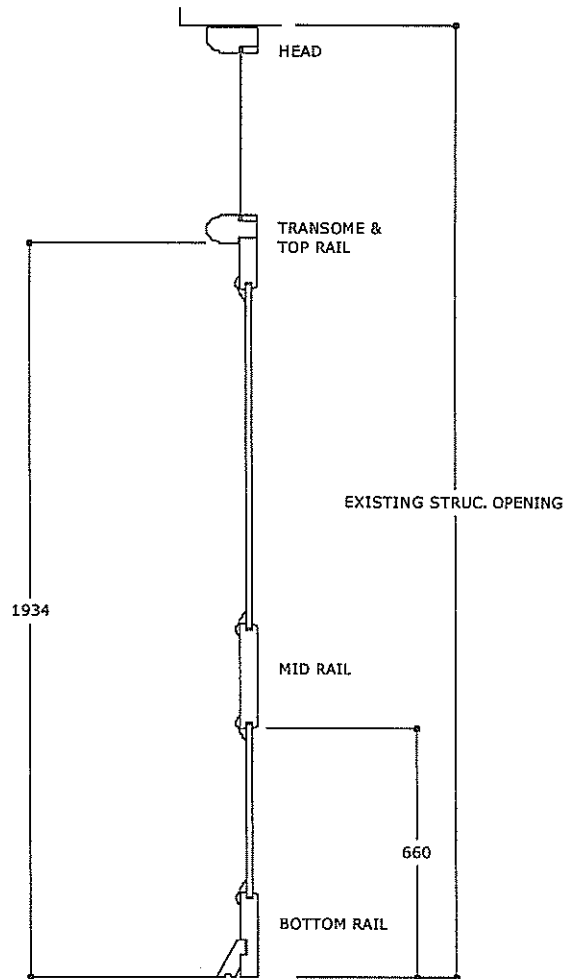

SECTION

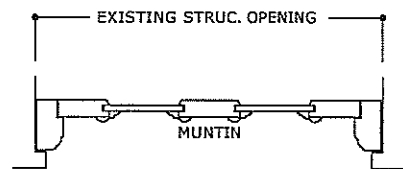

PLAN

4 PANEL DOOR  
ELEVATION PLAN  
& SECTION

1/20 SCALE

Head of Planning and Economic Regeneration

Civic Centre  
Newport  
South Wales

Telephone 01633 232163



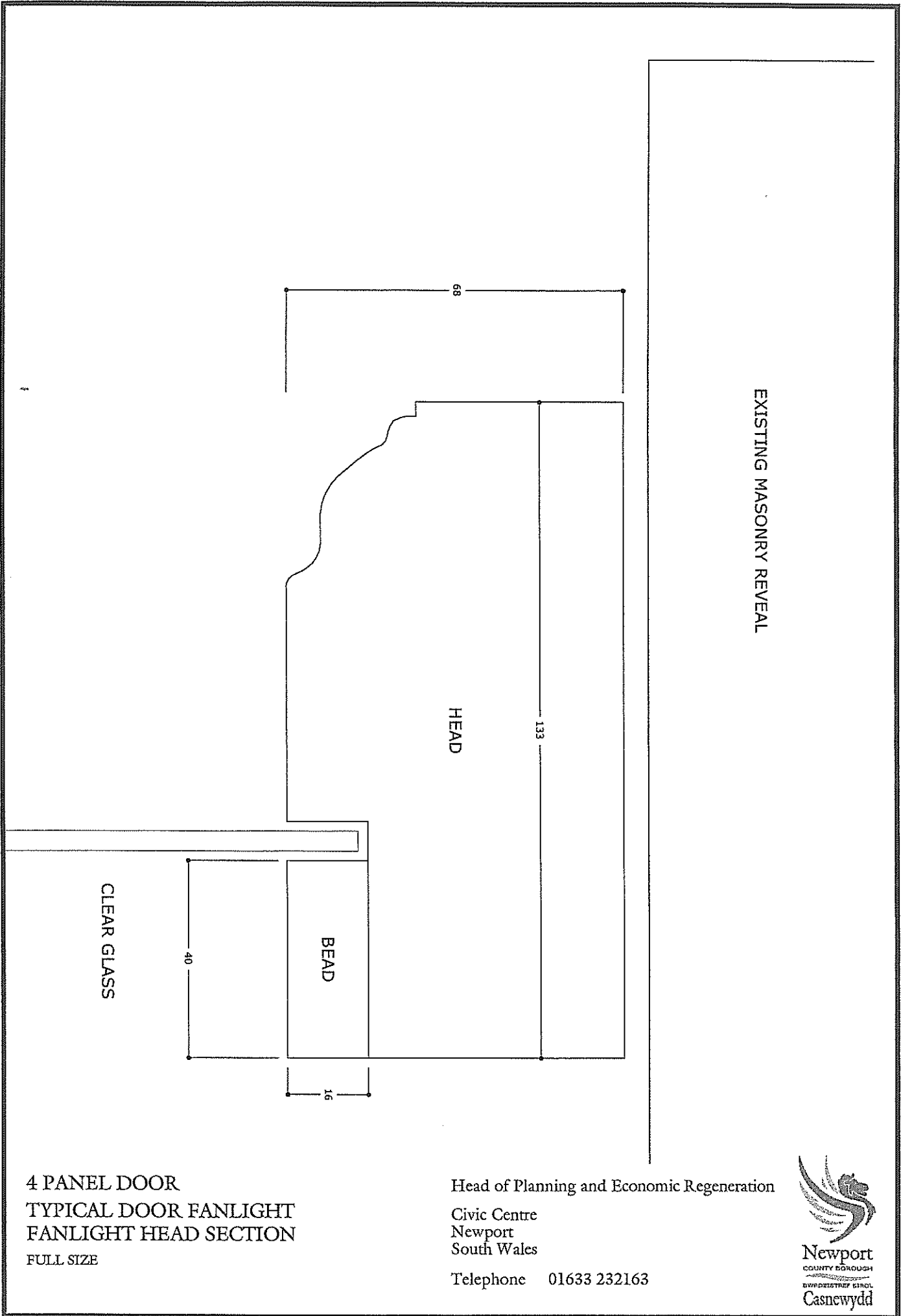

4 PANEL DOOR  
 TYPICAL DOOR FANLIGHT  
 FANLIGHT HEAD SECTION  
 FULL SIZE

Head of Planning and Economic Regeneration  
 Civic Centre  
 Newport  
 South Wales  
 Telephone 01633 232163



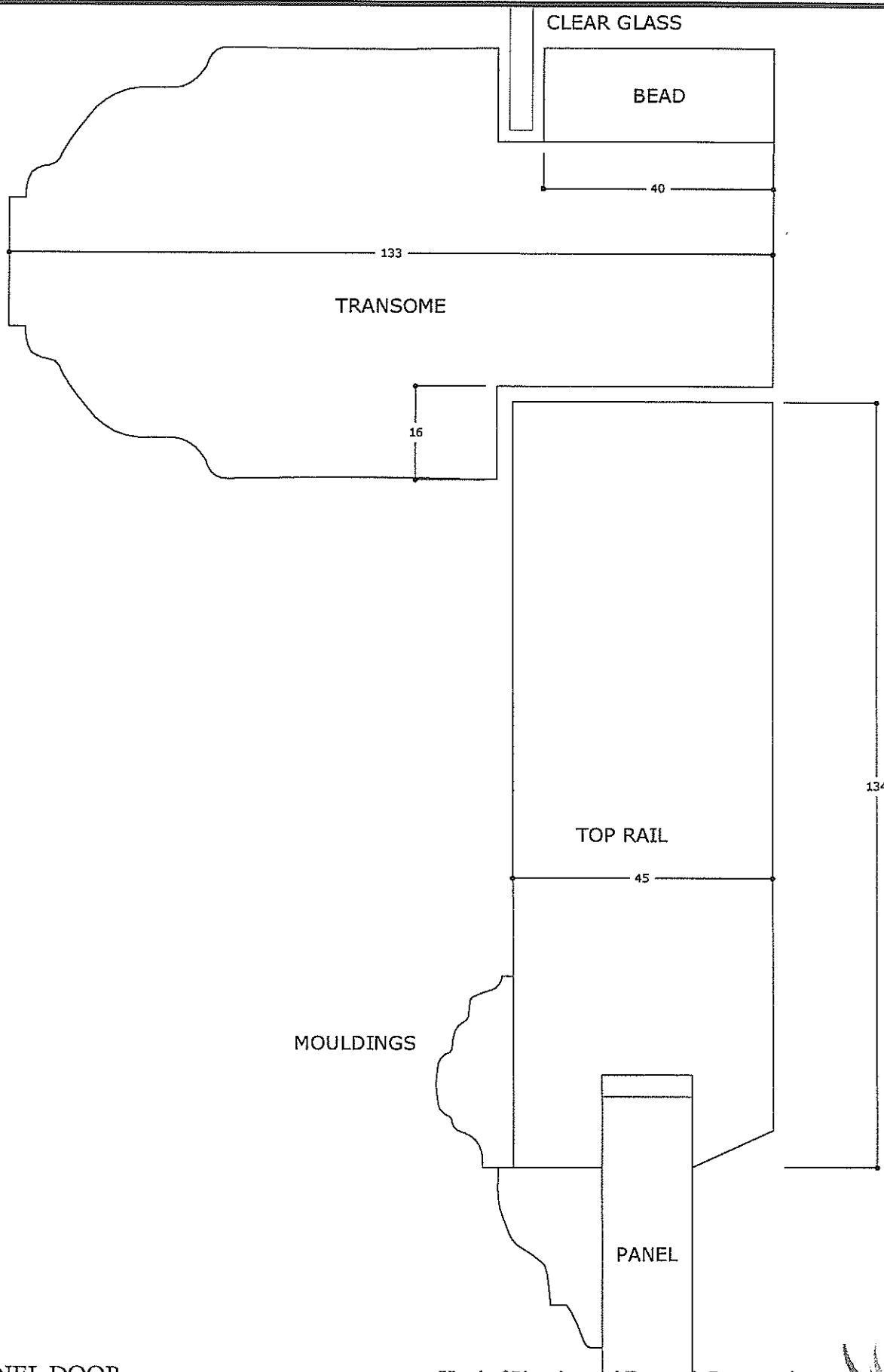

4 PANEL DOOR  
 TYPICAL DOOR TOP RAIL & TRANSOME  
 SECTION  
 FULL SIZE

Head of Planning and Economic Regeneration  
 Civic Centre  
 Newport  
 South Wales  
 Telephone 01633 232163



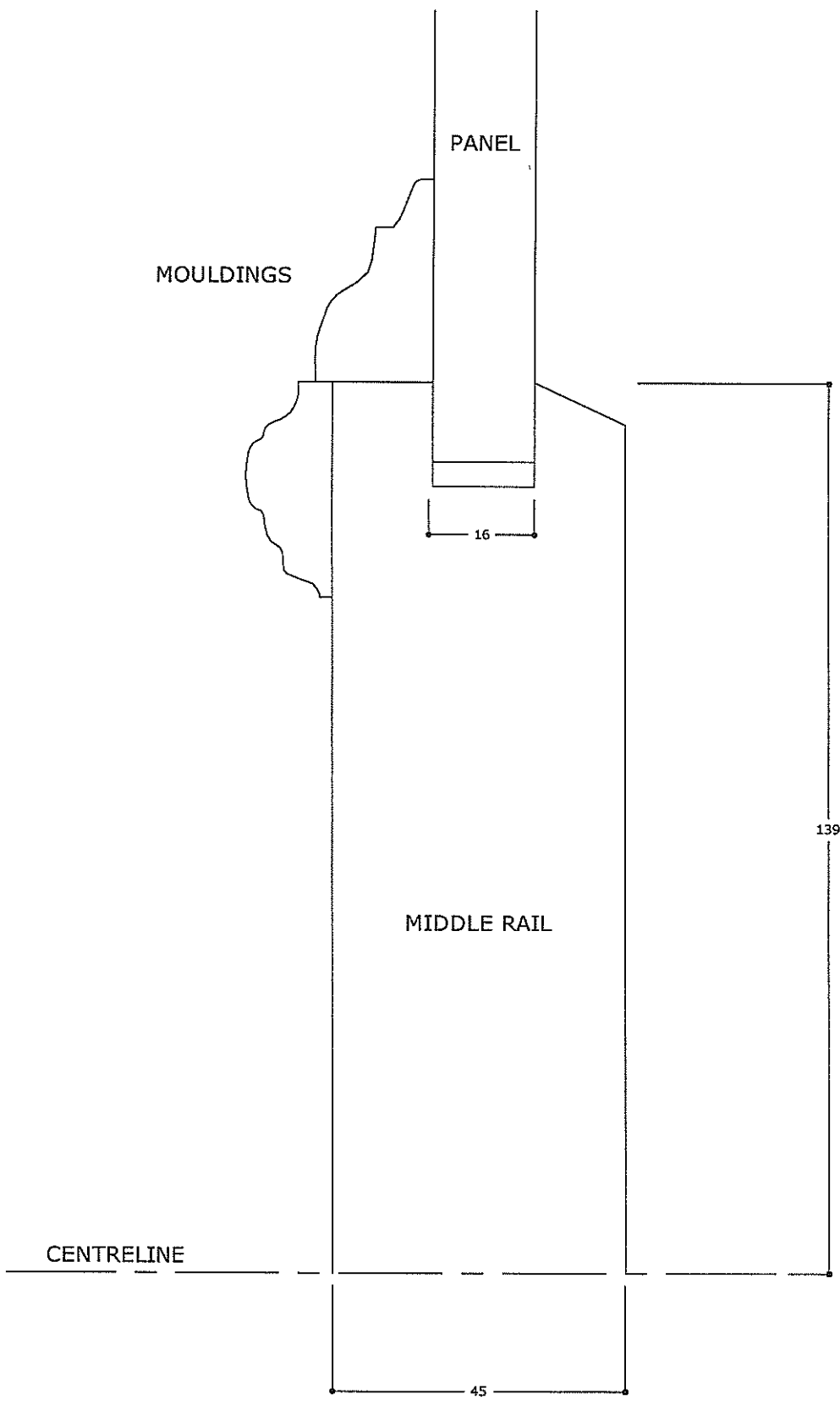

4 PANEL DOOR  
 TYPICAL DOOR MIDDLE RAIL  
 HALF SECTION  
 FULL SIZE

Head of Planning and Economic Regeneration  
 Civic Centre  
 Newport  
 South Wales  
 Telephone 01633 232163



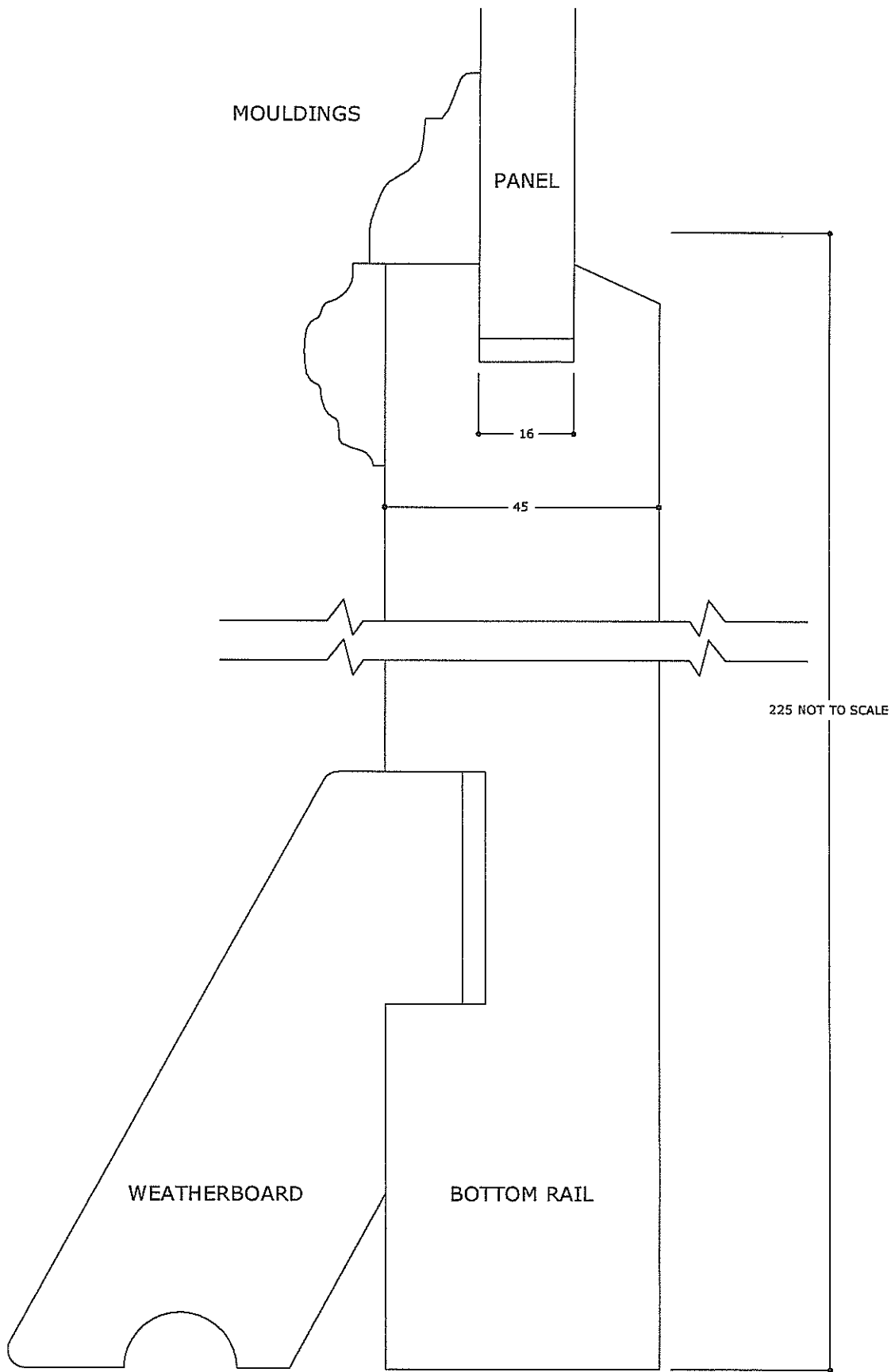

4 PANEL DOOR  
TYPICAL DOOR BOTTOM RAIL

FULL SIZE

Head of Planning and Economic Regeneration

Civic Centre  
Newport  
South Wales

Telephone 01633 232163



Newport  
COUNTY BOROUGH  
BWADEISTREF SIROL  
Casnewydd

EXISTING  
MASONRY  
REVEAL

45

JAMB

TO SUIT REVEAL

16

STILE

45

127

MOULDING

MOULDING

PANEL

16

4 PANEL DOOR  
TYPICAL JAMB & STILE SECTION

FULL SIZE

Head of Planning and Economic Regeneration

Civic Centre  
Newport  
South Wales

Telephone 01633 232163



Newport  
COUNTY BOROUGH  
BURDDEISTREF SIACL  
Casnewydd

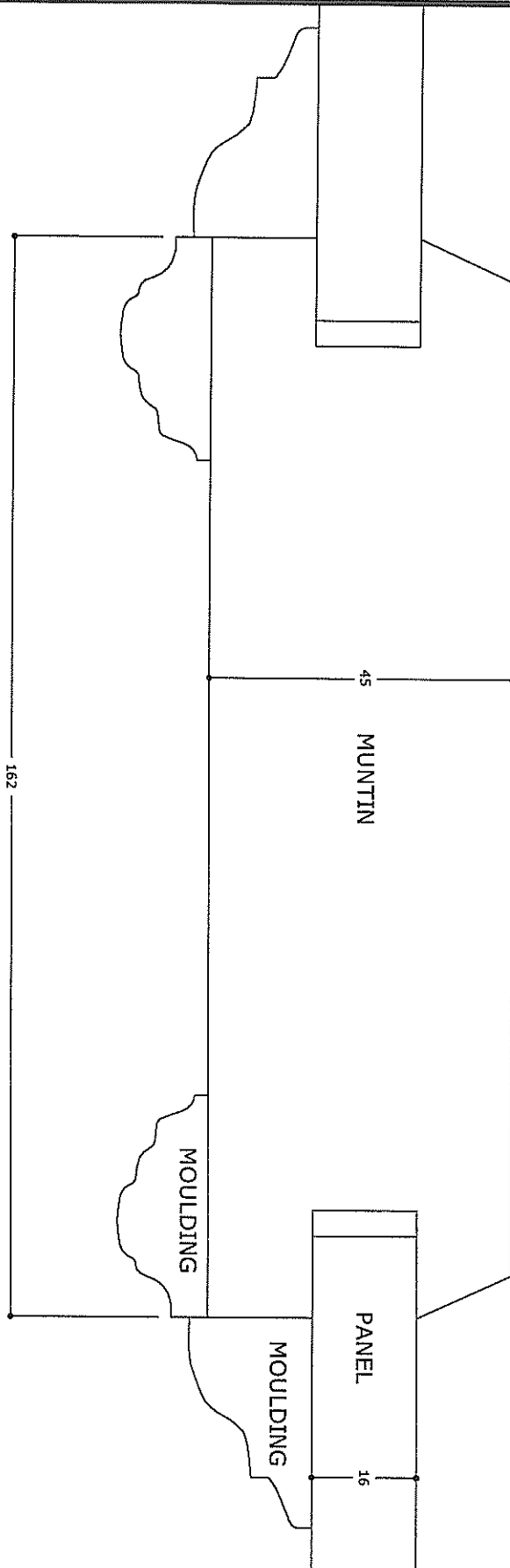

4 PANEL DOOR  
TYPICAL MUNTIN SECTION

FULL SIZE

Head of Planning and Economic Regeneration

Civic Centre  
Newport  
South Wales

Telephone 01633 232163



Newport  
COUNTY BOROUGH  
DYWIDETRYF SIRIOL  
Casnewydd



WHERE EXISTING BRICKWORK  
REMAINS:  
REPOINT & RESTORE

WHERE BRICKWORK HAS  
PREVIOUSLY BEEN RENDERED:  
HACK OFF & APPLY SMOOTH  
CEMENT RENDER WITH WOOD  
FLOAT FINISH

4 PANEL DOOR

2 OVER 2  
OR 4 OVER  
4 SASH WINDOWS

25MM DEEP X 300MM (APPROX) HIGH CEMENT RENDER PLINTH

DOLPHIN STREET  
TYPICAL ELEVATION

1/50 SCALE

Head of Planning and Economic Regeneration

Civic Centre  
Newport  
South Wales

Telephone 01633 232163







SOUTH MARKET STREET  
TYPICAL ELEVATION

FULL SIZE

Head of Planning and Economic Regeneration

Civic Centre  
Newport  
South Wales

Telephone 01633 232163

